



Catálogo de Aplicaciones  
Bujías de Pre calentamiento



Magneti Marelli ha creado una gama completa de bujías de precalentamiento diseñadas y fabricadas conforme a los estándares cualitativos internacionales, garantizando una amplia cobertura de vehículos circulantes. Todas las bujías de precalentamiento de Magneti Marelli llevan un doble filamento y pueden permanecer encendidas el tiempo necesario que establezca la centralina después de la puesta en marcha del motor.

- ✓ **Arranques en frío inmediatos, incluso en condiciones climáticas muy duras**
- ✓ **Reducción de los consumos y de las emisiones contaminantes**
- ✓ **Fiabilidad total**
- ✓ **Larga duración**

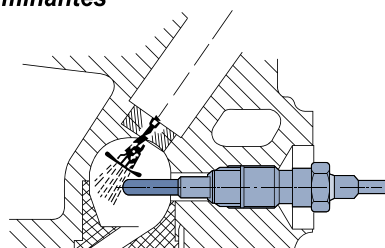

## Principio de Funcionamiento



- 1 Cuerpo doble base de apoyo y recubrimiento especial aislante.**  
Asegura perfectas características de estanqueidad y aislamiento.
- 2 Funda en superaleación anticorrosiva térmica y química.**  
Espesor variable en función de la temperatura específica para cada motor, que se desarrolla en el interior de la precámara.
- 3 Polvo aislante (Mg O) a alta compresión.**  
El compactamento, que elimina las intercapas de aire que perjudican la duración del filamento y que aísla perfectamente la espiral, es de particular importancia para la calidad exigida a una bujía de precalentamiento.
- 4 Filamento calentador.**  
Calienta rápidamente la mezcla para obtener un encendido rápido, incluso en condiciones extremas y mantiene alta la temperatura del motor una vez en marcha obteniendo emisiones más limpias.
- 5 Filamento regulador.**  
Gracias a sus características de resistencia controla el aumento de la temperatura para calentar la mezcla lo más rápido posible y así permitir que la bujía se mantenga caliente hasta 3 minutos sin riesgo de sufrir daños.
- 6 Soldadura del filamento, de calidad y control constante.**  
Realizada con proceso automatizado mediante fusión al láser.

## Prestaciones Eléctricas UX / UC / UZ / UY

MAGNETI MARELLI Ultra rápidas DOBLE FILAMENTO

La sinergia de estos componentes reduce el tiempo de espera logrando un funcionamiento óptimo a partir de los 2 segundos, otorgando un mejor rendimiento del motor y una significativa disminución de la descarga de gases incombustos.

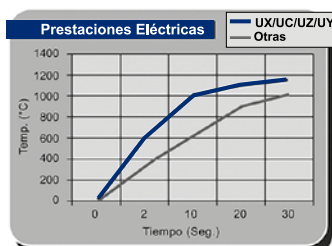

Tiempo Seg.	Normal °C	UX/UC/UZ/UY °C
0	0	0
2	350	600
10	600	1000
20	900	1100
30	1010	1150

APTAS PARA MOTORES INYECCIÓN ELECTRÓNICA  
DIESEL DE PRE Y POST CALENTAMIENTO

**Diesel**

## Indice

Detalles técnicos del producto

3

**Bujías de precalentamiento**  
Aplicaciones por marca y vehículo

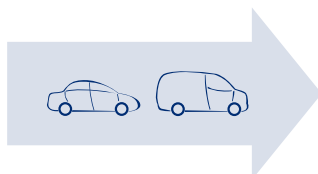

5

**Bujías de precalentamiento**  
Aplicaciones por Código



19

**Bujías de precalentamiento**  
Imágenes por tamaño

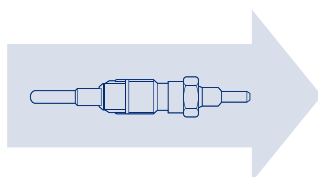

31

**Bujías de precalentamiento**  
Equivalencias por Código



53

**Bujías de Pre calentamiento**  
Aplicaciones por marca y vehículo

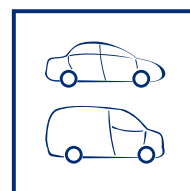

**MOTOR**

**ALFA ROMEO**

145 / 146 1.9 JTD	AR 33601-AR 67500	94 - 99	<b>UX20A</b>
145 / 146 / 156 1.9 JTD	AR 32302	98 - 99	<b>UC11A</b>
145 / 146 1.9 JTD	AR 32302	99 - 01	<b>UC19A</b>
145 / 146 / 155 2.0 JTD	AR 67501	94 - 95	<b>UX20A</b>
147 / 156 1.9 JTD	937 A2000	01 ->	<b>UC19A</b>
155 / 164 2.5 TD	VM 07 B-VM 31 B	93 - 95	<b>UX20A</b>
155 / 164 2.5 TD	VM 07 B-VM 31 B	95 - 97	<b>UC14A</b>
156 / 166 2.4 JTD	AR 32501-AR 34202	97 - 05	<b>UC11A</b>
156 / 166 2.4 JTD	839 A6000	00 ->	<b>UC19A</b>

**ARO**

10.1 / 10.4 1.9 D	Renault F8Q 248	86 - 91	<b>UX20A</b>
240 / 244 / 246 2.5 TD	Peugeot XD 3P/TP	83 - 93	<b>UX20A</b>

**AUDI**

80 AVANT 1.9 TDi	AAZ	91 - 96	<b>UC31A</b>
100 AVANT 2.5 TDi	AAT-ABP	90 - 94	<b>UC31A</b>
A3 1.9 TDi	ALH + ASV	97 - 01	<b>UX27A</b>
A3 1.9 TDi	AGR-ALH-AHF-ASV-ATD	96 ->	<b>UC31A</b>
A3 2.0 TDi	CRFA	11.13->	<b>UY7A</b>
A4 1.9 TDi	AHH-AHU-AFF-AWX	96 ->	<b>UC31A</b>
A4 1.9 TDi / Quattro	AJM	98 - 00	<b>UX27A*</b>
A4 2.0 TDi	CMEA	11.13->	<b>UY7A</b>
A4 3.0 TDi		11.10->	<b>UY7A</b>
A5 2.0 TDi	CMEA	12-13	<b>UY7A</b>
A6 1.9 TDi	AHU-AFN-AJM	94 ->	<b>UC31A</b>
A6 2.5 TDi	AEL	94 - 97	<b>UC31A</b>
A6 2.7 TDi	BPP	07.08->	<b>UY7A</b>
A6 3.0 TDi	BMK	07 - 12	<b>UY7A</b>
ALLROAD 2.7 Tdi	BPP	01.07 - 02.10	<b>UY7A</b>
ALLROAD 3.0 Tdi	CDYC	08.06 - 01.10	<b>UY7A</b>
Q3 2.0 Tdi		08.13->	<b>UY7A</b>
Q5 2.0 Tdi	CMBG	09.09->	<b>UY7A</b>

**MOTOR**

Q5 3.0 Tdi		09.09->	UY7A
Q7 3.0 Tdi		04.06->	UY7A

**BMW**

318 2.4 TDS	M41D18	95 ->	UX20A
320 2.0D	M47D20	98 ->	UC26A
325 2.5 TDS	M51D25	91 - 98	UX20A
524 2.4 TDi	M21D24	88 ->	UX20A
525 2.5 TDS	M51D25	91 ->	UX20A
530 3.0 D	M57D30	98 ->	UC26A
X3 3.0 D	M57N 30 6D2	04 - 05	UC02F
X5 3.0 D	M57N 30 6D2	03 - 06	UC02F
X5 3.0 D	M57D 30-30 6D1	01 - 03	UC26A
X5 3.0 D	M57N 2-30 6D3	07->	UC02F

**BORDWARD**

VM	VM		UX7A
----	----	--	------

**CHEVROLET**

ASTRA 1.7 TD	TC4EE1	91 - 96	UC9A
ASTRA 2.0 TD	Y20DTH/X20DTH	99 ->	UC16A
BLAZER 2.5 TD	MAXION 4A	93 - 00	UC24A
BLAZER 2.8	MWM 4.07 TCA	00 - 05	UC24A
CAPTIVA 2.0 CDRI	Z20S	06.18 ->	UY11A
COBALT 1.3 TD	Z13DT	02.13 ->	UY2A
CORSA 1.7D	ISUZU 4EE1/X17D	95 - 00	UZ1A
CORSA 1.7D	ISUZU 4EE1/X17D	97 - 00	UZ1B
CORSA 1.7 TD	Y 17DT	00 - 07	UZ2A
CORSA 1.7 TD	Y 17DT	00 - 08	UZ2B
CRUZE 2.0 CDI	LLW	09.18 ->	UY11A
LUV 2.5 D	4JA1	92 - 99	UC10A
LUV 2.5 TD	4JA1T	99 - 01	UC10A
MERIVA 1.7 TD	Y 17DT	03 - 09	UZ2A
MERIVA 1.7 TD	Y 17DT	03 - 09	UZ2B

**MOTOR**

S 10 2.5 TD	MAXION ROVER HST 2.5TD	99 ->	UC24A
S 10 2.8	MWM 4.07 TCA	00 - 05	UC24A
S 10 2.8 CTDi 4X2 / 4X4	MOTOR DURAMAX	12 ->	UY81A
SPIN 1.3 TD	Z13DT	02.13 ->	UY2A
VECTRA 2.0 DTI 16V	X 20 DTH	98 ->	UC16A

**CHRYSLER**

CARAVAN 2.5 TD	HR 425 CLIEE	95 - 03	UC14A
LAREDO / LIMITED 3.1 TDi		95 - 00	UC14A
VOYAGER 2.5 TD	HR 425 CLIEE	95 - 00	UC14A

**CITROËN**

AX 1.5D	VJY - VJZ	93 - 97	UC15A
BERLINGO 1.6 HdI	9HZ - DV6TED4	08 ->	UY5A
BERLINGO 1.9 D	D9B - DJI	98 ->	UX20A
BERLINGO 2.0 HDi	DW10TD (RHY)	99 ->	UC12A
BX 1.9 D	D9B	88 - 95	UX20A
C3 1.4 HDi	8HX	02 ->	UY1A
C3 1.4 HDi	8HW - DV4TD	03 - 12	UY5A
C4 1.6 HDi	9HZ - DV6TED4	07 ->	UY5A
C4 2.0 HDi	DW10BTED (RHR)	06 ->	UC12A
C4 GRAND PICASSO 1.6 HdI	9HZ - DV6TED4	08 ->	UY5A
C5 / C8 2.0 HDi	RHS	01 ->	UC12A
C5 / C8 2.2 HDi	4HX	01 ->	UC12A
C15 1.8 D	XUD7	86 - 97	UX20A
JUMPER 1.9 D	D9B	98 ->	UX20A
JUMPER 2.5 TDi	DJ5TED	96 ->	UC40A
PICASSO 2.0 HDi	RHY	00 ->	UC12A
SAXO 1.5 D	VJY - VJZ	96 ->	UC15A
XANTIA 1.9 TDi	D8B	95 ->	UX20A
XSARA 1.9 D	DJY	98 - 02	UX20A
XSARA 1.9 TDi	DHY	98 - 02	UX20A
XSARA 2.0 HDi	RHY	00 - 04	UC12A
ZX 1.9 D - TDi	XUD9TE (D8A)	94 - 98	UX20A



**MOTOR**

**DEUTZ**

DEUTZ F6L714 - FA(2/3/4/6) L (514/614/714/716/812)	Lápiz largo		<b>UX32A</b>
DEUTZ F(2/3/4/6/8/12) L (514/614/714/716)	Lápiz corto		<b>UX33A</b>

**FIAT**

147 SPAZIO 1.3 D	146 B 000	86 - 97	<b>UX20A</b>
307 1.6 Hdi	DV6TED4 - 9HZ/9HY	06 ->	<b>UY6A</b>
500 1.3 MJTD (16V)	169 A1.000	07.18-12.18	<b>UY2A</b>
BRAVO 1.6 JTD	198A20006	12.18->	<b>UY10A</b>
DUCATO 1.9 D	DJY	94 - 98	<b>UX20A</b>
DUCATO 1.9 TD	230 A 4000	94 - 02	<b>UX20A</b>
DUCATO 2.5 D	8144 77	94 - 02	<b>UX12A</b>
DUCATO 2.8 D	8140 63	97 ->	<b>UC2A</b>
DUNA / UNO / FIORINO 1.3 D	146 B 000	88 - 97	<b>UX20A</b>
DUNA / UNO / FIORINO 1.7 D	146 B 2000	91 - 01	<b>UX20A</b>
MAREA / BRAVA 1.9 TD	182 A 7000	98 ->	<b>UC4A</b>
MAREA / BRAVA 1.9 JTD	185 B 4000	00 - 02	<b>UC11A</b>
PALIO / SIENA / STRADA 1.7 TD	176 A 3000	96 ->	<b>UX20A</b>
PUNTO 1.3 JTD MULTIJET	188A9.000, 199A2.000, 223A9.000	09.09-12.18	<b>UY2A</b>
STRADA 1.3 JTD MULTIJET	188A9.000, 199A2.000, 223A9.000	10.18 ->	<b>UY2A</b>
TIPO 1.9 D - TD	160A7000 / 160D1000	92 - 96	<b>UX20A</b>
TORO 2.0 JTD 4WD	Multijet 16v-EURO 5	02.16 ->	<b>UY10A</b>
TORO 2.0 JTD 4X2	Multijet 16v-EURO 5	02.16 ->	<b>UY10A</b>

**FORD**

COURIER 1.8D	ENDURANCE	98 ->	<b>UX19A</b>
ECOSPORT 1.4 TDCi	F6JA / F6JB	02 ->	<b>UY1A</b>
ESCORT 1.8 D	ENDURA-DE 1.8L RFD / RFK	95 - 99	<b>UX11A</b>
ESCORT 1.8 TD	RVA	95 - 99	<b>UX19A</b>
F-100 2.5 TD	MAXION	98 ->	<b>UC24A</b>
FIESTA 1.8 D	ENDURA-DE 1.8L (RTC/RTD)	95 - 00	<b>UX19A</b>
FIESTA 1.4 TDCi	F6JA / F6JB	01 ->	<b>UY1A</b>
FOCUS 1.8 TDCi	Duratorq TDCi	98 ->	<b>UC22A</b>
FOCUS 2.0 TDCi	Duratorq TDCi	03 ->	<b>UY1A</b>
MONDEO 1.8 TD	RFN - Endura EURO 1	93 ->	<b>UX11A</b>

**MOTOR**

MONDEO 1.8 TD	EURO 2	93 ->	UX19A
MONDEO 1.8 TDCi	C9DC	98 ->	UC22A
MONDEO 2.0 TDCi	Duratorq TDCi	01 - 05	UC27A
MONDEO 2.2 TDCi	Duratorq TDCi	03 - 07	UC27A
RANGER 2.2 - 3.2 TDCi	GBVAJPF / GBVAJQW	11->	UC82A
RANGER 2.2 - 3.2 TDCi 4x4	GBVAJPF / GBVAJQJ	11->	UC82A
RANGER 2.2 Tdci PUMA		08.12->	UC82A
RANGER 3.2 Tdci PUMA		06.12->	UC82A
RANGER D/C 2.5 TDi	Maxion HS TD 4B	98 - 02	UC24A
RANGER S/C 2.5 TDi	Maxion HS TD 4B	97 - 02	UC24A
TRANSIT 2.2 Tdci PUMA		08.12->	UC82A
TRANSIT 2.4 Di	D4FA	00 - 06	UC27A

**HYUNDAI**

ACCENT 1.5 CRDi	D3EA	02 - 05	UC33A
ELANTRA 2.0 CDRi	D4EA	01 - 06	UC33A
GALLOPER 2.5 TD	INTERCOOLER D4BH	98 ->	UC23A
H-1 2.5 TD	D4BF / H	97 ->	UC23A
H-100 2.5 TD	D4BF	94 - 00	UC23A
SANTA FE 2.0 CDRi	D4EA	01 - 06	UC33A
TUCSON 2.0 CDRi	D4EA	04 - 08	UC33A
TRAJET 2.0 CDRi	D4EA	01 - 06	UC33A

**IME**

RASTROJERO Bordward 52HP / Indenor 2.0 4.88	Lápiz largo		UX32A
RASTROJERO Bordward 42HP	Lápiz Corto		UX33A

**ISUZU**

PICK UP 2.5 D	4JA1	94 ->	UC10A
RODEO	C223	87 ->	UC10A

**IVECO**

DAILY 2.4 D	SOFIN 8140.61	83 - 89	UX20A
DAILY 2.8 TD		98 ->	UC37A

**MOTOR**

**JAGUAR**

X-TYPE 2.0 D	FMBA, FMBB, R4X404	03 - 09	UC27A
--------------	--------------------	---------	-------

**JEEP**

CHEROKEE 2.1 TD	J8S	89 - 94	UX14A
CHEROKEE 2.1 TD	J8S 814-890	91 - 95	UX20A
CHEROKEE 2.5 TD	VM HR 425 C LIRX	88 - 95	UX20A
CHEROKEE 2.5 TD	VM HR 425 C LIRX	95 - 00	UC14A
GRAND CHEROKEE 2.5 / 2.7 / 3.1	M51 / M 52	95 - 00	UC14A
GRAND CHEROKEE / VOYAGER 2.5 TD	HR425 CLI	95 - 00	UC14A

**LADA**

ALEKO 1.8 D	RTE, RTS (FORD)	90 ->	UX11A
NIVA 1.9 D	XUD9A (PEUGEOT)	93 ->	UX20A
NIVA 1.9 D	XUD9SD (PEUGEOT)	99 ->	UX20A
SAMARA 1.5 D	XUD9L	95 ->	UC15A

**LAND ROVER**

DEFENDER 90 2.5 TDi	200/300 TDI	90 ->	UC24A
DISCOVERY 2.5 TDi	12L / 21 L	89 - 94	UC24A
DISCOVERY 2.5 TDi	19 L	95 ->	UC24A
FREELANDER 2.0 Di		98 ->	UC8A
FREELANDER 2.0 TD4	M47D20	00 ->	UC26A
RANGE ROVER 2.4 D	11A	86 - 90	UX7A
RANGE ROVER 2.5 D	14L / 25 6T	94 - 02	UX20A
RANGE ROVER 3.0 TD	M57D30	02 ->	UC26A

**MERCEDES BENZ**

100 2.4 D	OM 616.963 / 616.9	88 - 96	UX13A
180		91 ->	UX13A
190 2.0D - 2.5 D	OM 601.911 / OM 602.911	89 - 93	UX13A
190 2.5 D - TD	OM 602.911 / OM 602.961	85 - 89	UX20A
200 2.0	OM615.940 / OM 615.912	80 - 89	UX20A
240 2.4 D	OM 616.912	80 - 85	UX20A

**MOTOR**

300 3.0	OM 617A	77 - 87	<b>UX20A</b>
300 3.0	OM 603.971	92 - 93	<b>UX13A</b>
C200 / C220 2.0 CDi	OM 611.960	98 - 00	<b>UC17A</b>
C200 2.0	OM 601.913	93 - 00	<b>UX13A</b>
C200 / C220 2.0	OM 604.915	96 - 00	<b>UX17A</b>
C220 2.0	OM 604.910	96 - 00	<b>UX16A</b>
C250 2.5 D	OM 605.910	93 - 00	<b>UX16A</b>
C250 2.5 D	OM 605.910	93 - 00	<b>UX17A</b>
C200 2.0D		00 ->	<b>UC17A</b>
C220 2.2 CDi	OM 611.962	00 ->	<b>UC17A</b>
C270 2.7 CDi	OM 612.962	01 ->	<b>UC17A</b>
E200 2.0D - 2.5 TD	OM 612.912 / OM 602.962	93 - 95	<b>UX13A</b>
E250 2.5 D	OM 605.911	93 - 95	<b>UX16A</b>
E300 3.0 D	OM 606.910	93 - 95	<b>UX16A</b>
E200 2.0 CDi	OM 611.960	98 - 02	<b>UC17A</b>
E200 2.0 D	OM 604.917	96 - 02	<b>UX17A</b>
E220 2.2 CDi	OM 611.960 / 611.961	99 ->	<b>UX17A</b>
E270 2.7 CDi	OM 647.961	02 ->	<b>UX17A</b>
E320 3.2 CDi		02 ->	<b>UX17A</b>
E400 4.0 CDi		03 ->	<b>UX17A</b>
S300 3.0 TD	OM 606.961	96 - 99	<b>UX17A</b>
S350 3.5 TD	OM 603.971	93 - 98	<b>UX13A</b>
S320 3.2 CDi	OM 613.960	00 - 02	<b>UC17A</b>
S400 4.0 CDi	OM 628.960	00 ->	<b>UC17A</b>
SPRINTER 2.5 TD	MAXION ROVER HST 2.5TD	95 - 00	<b>UC24A</b>
SPRINTER 2.9	OM 602.980	95 - 00	<b>UX20A</b>
SPRINTER 2.9	OM 602.980	95 - 00	<b>UX23A</b>
SPRINTER 2.3 D		95 - 00	<b>UX13A</b>
SPRINTER 2.2 CDi		00 ->	<b>UC17A</b>
VIANO 2.2 CDi	OM 611.980	03 ->	<b>UC17A</b>
VIANO 2.3 D - TD	OM 601.942	96 - 99	<b>UX13A</b>
VIANO 2.1 CDi	OM 611.960	98 - 03	<b>UC17A</b>
VITO 2.3D - TD	OM 611.970	99 - 02	<b>UX13A</b>
VITO 2.2 CDi		96 ->	<b>UC17A</b>

**MOTOR**

**MITSUBISHI**

L200 2.5 D - TD	4D56	95 ->	UZ4B
SPACE WAGON 2.0 TD	4D65 SHC	92 - 00	UZ4B

**NISSAN**

FRONTIER 2.5 DCi 4WD	YD25DDTI	12 ->	UZ80B
FRONTIER 2.5 DCi 4WD	YD25DDTI	10 ->	UZ80B
FRONTIER 2.5 DCi 4WD	YD25DDTI	10 ->	UZ80B
FRONTIER 2.5 DCi	YD25DDTI	12 ->	UZ80B
FRONTIER 3.0 DCi 4WD	VX9	10 ->	UZ80B
MURANO 2.5 4x4		10 ->	UZ80B
PATHFINDER 2.5 D	TD25	93 - 02	UC23A
PATHFINDER 2.5 DCi 4WD	YD25DDTI	10 ->	UZ80B
PATHFINDER 2.7 D	TD27	93 - 02	UC36A
PATHFINDER 2.7 TD	TD27ETi	97 ->	UC23A
PATHFINDER 3.0 DCi	VX9	10 ->	UZ80B
PATROL 2.7 D	TD27	93 - 02	UC23A
PATROL 4.2 TD	TD42	92 - 98	UC23A
PICK UP 2.5 D	TD25	89 - 98	UC23A
PICK UP 2.7 D	TD27	87 - 98	UC23A
TERRANO II	TD27ETi	93 - 02	UC23A
X-Terra 2.8 TDi	MWM 4.07 TCA	03 - 09	UC24A
X-Trail 2.0 DCi - DCi FWD	M9R / M9R 760	07 ->	UZ80B

**PEUGEOT**

106 1.5 D	VJY / X	94 ->	UC15A
205 1.9 D	XUD9	87 ->	UX20A
206 1.4 HDi	DV4TD (8HX)	01 ->	UY1A
206 1.9 D	DW8 (WJZ)	98 - 01	UC15A
206 2.0 HDi	DW10TD (RHY)	99 ->	UC12A
306 1.8 - 1.9 D	XUD7	98 ->	UX20A
306 1.9 D - TD	DW8 / DHV	98 ->	UC15A
306 1.9 TD	D8B XUD9 A/L	93 - 00	UX20A
306 2.0 TD	DW10TD	98 ->	UC12A

**MOTOR**

306 2.0 HDi	DW10TD	99 ->	<b>UC12A</b>
307 1.6 Break Hdi SW	DV6TED4 - 9HZ/9HY	06 ->	<b>UY5A</b>
307 2.0 HDi	DW10TD (RHY)	03 ->	<b>UC12A</b>
404D 1.9	INDENOR / XD4.88	76 - 78	<b>UX32A</b>
405 1.9 D	XUD9A / Y	88 ->	<b>UX20A</b>
406 2.0 D	DW10TD	98 ->	<b>UC12A</b>
406 2.1 TD	XUD11ATE	95 - 98	<b>UX20A</b>
406 2.2 HDi	DW12TEDA/F	00 ->	<b>UC12A</b>
407 2.0 HDi	DW10TD	04 ->	<b>UC12A</b>
504 2.3	XD4.88 / XD2	83 ->	<b>UX20A</b>
504 Indenor		75 ->	<b>UX32A</b>
504 GL / GRD / SRD 1.9 / 2.1 / 2.3	XD2 / X4.88 / X4.90	70 - 78	<b>UX32A</b>
505 2.3	XD2	81 ->	<b>UX20A</b>
505 2.5	XD3-T	81 ->	<b>UX20A</b>
806 2.0 HDi	DW10TD (RHY)	<- 03	<b>UC12A</b>
807 2.0 HDi	DW10ATED (RHS)	02 ->	<b>UC12A</b>
3008 1.6 Hdi	DV6TED4 - 9HZ	09 ->	<b>UY5A</b>
BOXER 1.9 D - TD	XUD9AU (DB9)	94 ->	<b>UX20A</b>
BOXER 2.5 D	DJ5 (T9A)	94 ->	<b>UX20A</b>
BOXER 2.5 TDi	DJ5TED	96 ->	<b>UC40A</b>
BOXER 2.8 D	F.28D	99 - 04	<b>UC2A</b>
DUCATO 2.3 MJ	F1AE0481T	10 ->	<b>UY6A</b>
EXPERT 1.6 Hdi	DV6TED4 - 9HU	07 ->	<b>UY5A</b>
EXPERT 1.9 D	XUD9AU	96 - 02	<b>UX20A</b>
EXPERT 2.0 HDi	DW10ATED	03 - 08	<b>UC12A</b>
PARTNER 1.6 Hdi	DV6TED4 - 9HZ	08 ->	<b>UY5A</b>
PARTNER 1.9 D	XUD9AU	96 ->	<b>UX20A</b>
PARTNER 1.9 D	DW8B	98 ->	<b>UC15A</b>
PARTNER 2.0 HDi	DW10TD	00 ->	<b>UC12A</b>

**RENAULT**

18 2.1 D	J8S / J8S 712	86 - 92	<b>UX20A</b>
19 1.9 D	F8Q	94 - 98	<b>UX20A</b>
21 2.1	J8S	91 - 94	<b>UX20A</b>

**MOTOR**

CLIO 1.9 D	F8Q 676 / 678 / 696	91 - 98	<b>UX22A</b>
CLIO 1.9 D	F8Q 730 / 732	91 - 98	<b>UX14A</b>
CLIO 1.9 D	F8Q 678	97 - 98	<b>UX14A</b>
CLIO II 1.5DCi	K9K 700 / 704 / 702	01 ->	<b>UC31A</b>
CLIO II 1.9 D	F8Q 630	98 ->	<b>UC21A</b>
CLIO II 1.9 D	F8Q 632	99 ->	<b>UC30A</b>
EXPRESS 1.9 D	F8Q 640 / 682	96 ->	<b>UX22A</b>
KANGOO 1.5 DCi	K9K 700 / 704 / 702	01 ->	<b>UC31A</b>
KANGOO 1.9 D	F8Q 632	99 ->	<b>UC30A</b>
KANGOO 1.9 TDi	F9Q 780	00 ->	<b>UC31A</b>
LAGUNA 1.9 DCi	F9Q 718 / 750 / 756	99 ->	<b>UC31A</b>
LAGUNA 1.9 TD	F9Q 751	03 ->	<b>UC31A</b>
LAGUNA 1.9 TDi	F9Q 710	97 - 01	<b>UC31A</b>
LAGUNA 1.9 TDi	F9Q 716	97 - 01	<b>UC8A</b>
LAGUNA 2.2 D	G8T 706 / 752 / 790	93 - 01	<b>UC8A</b>
LAGUNA 2.2 TD	G8T 760	96 - 01	<b>UC8A</b>
MASTER 2.5 DCi 120	G9U 724	01 ->	<b>UC29A</b>
MASTER 2.5 TD	S8V 770	98 - 01	<b>UX11A</b>
MASTER 2.8 TDi	SOFIN	97 ->	<b>UC37A</b>
MASTER 2.8 TDi	S9W 702	98 - 01	<b>UC37A</b>
MASTER III Bus 2.3 DCi 125	M9T 670, 672, 676	10->	<b>UZ80B</b>
MEGANE 1.9 D	F8Q 622 / 790	99 ->	<b>UC30A</b>
MEGANE 1.9 D	F8Q 620 / 624	96 ->	<b>UX22A</b>
MEGANE 1.9 DCi	F9Q 732 / 733	01 ->	<b>UC31A</b>
MEGANE 1.9 TD	F8Q 784 / 786	96 ->	<b>UX18A</b>
MEGANE 1.9 TDi	F9Q 744 / 736	01 ->	<b>UC31A</b>
MEGANE 1.9 TDi	F9Q 730 / 734	97 - 01	<b>UC8A</b>
MEGANE II 1.5DCi	K9K 728	02 ->	<b>UC31A</b>
MEGANE II 1.9 DCi	K9K 722	02 ->	<b>UC31A</b>
SCENIC 1.9 D	F8Q 620	97 - 99	<b>UX22A</b>
SCENIC 1.9 TD	F8Q 784 / 786	97 - 99	<b>UX18A</b>
TRAFIC 2.1 D		89 - 97	<b>UX20A</b>
TRAFIC 2.5 D	SV8 750	97 - 01	<b>UX11A</b>

**MOTOR**

**ROVER**

25 2.0 TDi		99 ->	UC8A
45 2.0 TDi		00 ->	UC8A
75 2.0 TDi	M47D20	99 ->	UC26A
220 2.0	20T2R / 20T2N	95 - 00	UC8A
420 2.0	20T2R / 20T2N	95 - 00	UC8A
620 2.0	20T2N	94 - 99	UC8A

**SEAT**

CORDOBA 1.9 D	1Y	93 - 96	UX8A
CORDOBA 1.9 SDi	AEF / AEY	96 - 99	UC31A
CORDOBA 1.9 SDi	ASY	02 - 06	UC14A
CORDOBA 1.9 TDi	AGR / ALH	96 - 99	UC31A
CORDOBA 1.9 TDi	ASZ / ATD	02 - 06	UC14A
CORDOBA 1.9 TDi	ALH + 1Z + ALH	96 - 01	UX27A
IBIZA 1.9 TDi	AGR / ALH	96 - 99	UC31A
IBIZA 1.9 TDi	ASZ / ATD	02 - 06	UC14A
IBIZA 1.9 TDi	AGR	99 - 02	UX27A
INCA 1.9 D	1Y	93 - 96	UX8A
LEON 1.9 TDi	ALH + ASV	99 - 04	UX27A
LEON 1.9 TDi	ARL	01 ->	UC31A
LEON 1.9 TDi	ASZ / ARL	03 - 06	UC14A
TOLEDO 1.9 TDi	ARL	99 ->	UC31A
TOLEDO 1.9 TDi	ASZ / ARL	03 - 05	UC14A
TOLEDO 1.9 TDi	AGR + ASV	99 - 03	UX27A

**SSANGYONG**

KORANDO 2.3 - 2.9		95 ->	UX13A
MUSSO 2.3 - 2.9		95 ->	UX13A

**SUZUKI**

GRAN VITARA 2.0 HDi	DW10TD (RHY)	01 ->	UC12A
GRAN VITARA 2.0 TD	MAZDA RF	98 ->	UC12A
GRAN VITARA 2.0 TDi		94 ->	UC10A



**MOTOR**

VITARA 1.9 D	XUD9A	95 - 98	UX20A
VITARA 2.0 TDi		94 - 98	UC12A

**TOYOTA**

COROLLA 2.0	2C	92 - 97	UC38A
COROLLA 2.0	2C-E	97 - 00	UC38A
DYNA	2.0/3.0	88- 95	UC5A
HI LUX 2.8 D, 4WD	3L	95 - 98	UC5A
HI LUX II Pick Up 2.4 D	2L	88 - 97	UC5A
HI LUX II Pick Up 2.5 D-4D	2KD-FTV	01 ->	UC35A
HI LUX III Pick Up 3.0 D	1KD-FTV	06->	UC53A
HI LUX III Pick Up 3.0 D-4D 4x4	1KD-FTV	07->	UC53A
SW4 3.0T		96 - 04	UC49A
SW4 3.0 D-4D 4x4	1KD-FTV		UC53A

**VOLKSWAGEN**

AMAROK 2.0 Bi TDi / 4 motion	CDCA	10 ->	UY7A
AMAROK 2.0 Bi TDi / 4 motion	CDBA	10 ->	UY7A
AMAROK 2.0 TDi 143CV		12.10->	UY7A
AMAROK 2.0 TDi 180CV		12.10->	UY7A
BORA 1.9 TDi	AGP/ AQM/ AGR/ ALH/ AHF/ ASV	98 - 01	UC31A
BORA 1.9 TDi	AGP/ AQM/ AGR/ ALH/ AHF/ ASV	98 - 01	UX8A
BORA 1.9 TDi	ASZ/ AXR/ ATD	04 - 06	UC14A
BORA 1.9 TDi	D5252T	98 - 05	UX27A
CADDY 1.9 Sd	AEY	95 ->	UC31A
CC 2.0 TDi	CBAA	11->	UY7A
GOL 1.6	AP 1.6D BE	93 ->	UX8A
GOL 1.9 D - TD	EA086 1.9SD 1Y	93- ->	UX8A
GOL 1.9 Sd	EA086 1.9SD BGG	93 ->	UC31A
GOLF III 1.9 G TD	AAZ	91 - 99	UX8A
GOLF III 1.9 Sd	AEY	97 - 99	UC31A
GOLF III 1.9 TDi	1Z / AHU/ ALE / AFN	95 - 98	UC31A
GOLF IV 1.9 TDi	D5252T	01 - 07	UX27A
GOLF IV 1.9 TDi	AGP/ AQM/ AGR/ ALH/ AHF/ ASV	98 - 01	UC31A



**MOTOR**

GOLF IV 1.9 TDi	AGP/ AQM/ AGR/ ALH/ AHF/ ASV	98 - 01	<b>UX8A</b>
GOLF IV 1.9 TDi	ASZ/ AXR/ ATD	01 ->	<b>UC14A</b>
NEW BEETLE 1.9 TDi	D4192T3	00 - 05	<b>UX27A</b>
PASSAT 1.9 TDi	AGP/ AQM/ AGR/ ALH/ AHF/ ASV	98 - 01	<b>UC31A</b>
PASSAT 1.9 TDi	AGP/ AQM/ AGR/ ALH/ AHF/ ASV	98 - 01	<b>UX8A</b>
PASSAT 1.9 TDi	ASZ/ AXR/ ATD	01 - 05	<b>UC14A</b>
PASSAT 1.9 TDi / VARIANT	D5252T	93 - 05	<b>UX27A</b>
PASSAT 2.0 Tdi	CBAB	02.06 - 12.11	<b>UY7A</b>
PASSAT 2.0 Tdi	CLLA	09.12->	<b>UY7A</b>
POLO 1.9 SD	1Y / AEY	96 ->	<b>UC31A</b>
POLO 1.9 TDi	AFN / ASV	96 ->	<b>UC31A</b>
SAVEIRO 1.6	AP 1.67D BE	93 ->	<b>UX8A</b>
SAVEIRO 1.9 D - TD	EA086 1.9SD 1Y	93 ->	<b>UX8A</b>
SENDA 1.6	AP 1.6D BE	93 ->	<b>UX8A</b>
SHARAN 1.9 TDi	AGP/ AQM/ AGR/ ALH/ AHF/ ASV	98 - 01	<b>UC31A</b>
SHARAN 1.9 TDi	AGP/ AQM/ AGR/ ALH/ AHF/ ASV	98 - 01	<b>UX8A</b>
SHARAN 1.9 TDi	ASZ/ AXR/ ATD	01 - 10	<b>UC14A</b>
TIGUAN 2.0 Tdi	CBAB	02.09->	<b>UY7A</b>
TOUAREG 3.0 Tdi	CASA	11->	<b>UY7A</b>

**VOLVO**

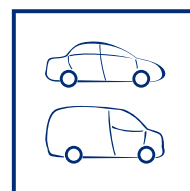

850 TDi	D5252T	96 - 97	<b>UX27A</b>
S70 TDi	D5252T	97 - 00	<b>UX27A</b>
V40 1.9 D	D4192T3	00 - 04	<b>UX27A</b>
V70 I 2.5TDi	D5252T	97 - 00	<b>UX27A</b>

**Bujías de Pre calentamiento**  
Aplicaciones por código





			<b>MOTOR</b>	
<b>UC02F</b>	BMW	X3 3.0 D	M57N 30 6D2	04 - 05
			M57N 30 6D2	03 - 06
			M57N 2-30 6D3	07->
<b>UC10A</b>	CHEVROLET	LUV 2.5 D	4JA1	92 - 99
		LUV 2.5 TD	4JA1T	99 - 01
	ISUZU	PICK UP 2.5 D	4JA1	94 ->
		RODEO	C223	87 ->
	SUZUKI	GRAN VITARA 2.0 TDi		94 ->
<b>UC11A</b>	ALFA ROMEO	145 / 146 / 156 1.9 JTD	AR 32302	98 - 99
		156 / 166 2.4 JTD	AR 32501-AR 34202	97 - 05
	FIAT	MAREA / BRAVA 1.9 JTD	185 B 4000	00 - 02
<b>UC12A</b>	CITROËN	BERLINGO 2.0 HDi	DW10TD (RHY)	99 ->
		C4 2.0 HDi	DW10BTED (RHR)	06 ->
		C5 / C8 2.0 HDi	RHS	01 ->
		C5 / C8 2.2 HDi	4HX	01 ->
		PICASSO 2.0 HDi	RHY	00 ->
		XSARA 2.0 HDi	RHY	00 - 04
	PEUGEOT	206 2.0 HDi	DW10TD (RHY)	99 ->
		306 2.0 HDi	DW10TD	99 ->
		306 2.0 TD	DW10TD	98 ->
		307 2.0 HDi	DW10TD (RHY)	03 ->
		406 2.0 D	DW10TD	98 ->
		406 2.2 HDi	DW12TEDA/F	00 ->
		407 2.0 HDi	DW10TD	04 ->
		806 2.0 HDi	DW10TD (RHY)	<- 03
		807 2.0 HDi	DW10ATED (RHS)	02 ->
		EXPERT 2.0 HDi	DW10ATED	03 - 08
		PARTNER 2.0 HDi	DW10TD	00 ->
	SUZUKI	GRAN VITARA 2.0 HDi	DW10TD (RHY)	01 ->
		GRAN VITARA 2.0 TD	MAZDA RF	98 ->
		VITARA 2.0 TDi		94 - 98
	<b>UC14A</b>	ALFA ROMEO	155 / 164 2.5 TD	VM 07 B-VM 31 B
CHRYSLER		CARAVAN 2.5 TD	HR 425 CLIEE	95 - 03

			<b>MOTOR</b>		
<b>UC14A</b>	CHRYSLER	LAREDO / LIMITED 3.1 TDi		95 - 00	
		VOYAGER 2.5 TD	HR 425 CLIEE	95 - 00	
	JEEP	CHEROKEE 2.5 TD		VM HR 425 C LIRX	95 - 00
		GRAND CHEROKEE / VOYAGER 2.5 TD		HR425 CLI	95 - 00
		GRAND CHEROKEE 2.5 / 2.7 / 3.1		M51 / M 52	95 - 00
	SEAT	CORDOBA 1.9 SDi		ASY	02 - 06
		CORDOBA 1.9 TDi		ASZ / ATD	02 - 06
		IBIZA 1.9 TDi		ASZ / ATD	02 - 06
		LEON 1.9 TDi		ASZ / ARL	03 - 06
		TOLEDO 1.9 TDi		ASZ / ARL	03 - 05
	VOLKSWAGEN	BORA 1.9 TDi		ASZ/ AXR/ ATD	04 - 06
		GOLF IV 1.9 TDi		ASZ/ AXR/ ATD	01 ->
		PASSAT 1.9 TDi		ASZ/ AXR/ ATD	01 - 05
		SHARAN 1.9 TDi		ASZ/ AXR/ ATD	01 - 10
	<b>UC15A</b>	CITROËN	AX 1.5D	VJY - VJZ	93 - 97
SAXO 1.5 D			VJY - VJZ	96 ->	
LADA		SAMARA 1.5 D	XUD9L	95 ->	
PEUGEOT		106 1.5 D		VJY / X	94 ->
		206 1.9 D		DW8 (WJZ)	98 - 01
		306 1.9 D - TD		DW8 / DHV	98 ->
		PARTNER 1.9 D		DW8B	98 ->
<b>UC16A</b>	CHEVROLET	ASTRA 2.0 TD	Y20DTH/X20DTH	99 ->	
		VECTRA 2.0 DTI 16V	X 20 DTH	98 ->	
<b>UC17A</b>	MERCEDES BENZ	C200 / C220 2.0 CDi	OM 611.960	98 - 00	
		C200 2.0D		00 ->	
		C220 2.2 CDi	OM 611.962	00 ->	
		C270 2.7 CDi	OM 612.962	01 ->	
		E200 2.0 CDi	OM 611.960	98 - 02	
		S320 3.2 CDi	OM 613.960	00 - 02	
		S400 4.0 CDi	OM 628.960	00 ->	
		SPRINTER 2.2 CDi		00 ->	
		VIANO 2.1 CDi	OM 611.960	98 - 03	
		VIANO 2.2 CDi	OM 611.980	03 ->	
		VITO 2.2 CDi		96 ->	



MAGNETI MARELLI		MOTOR		
UC19A	ALFA ROMEO	145 / 146 1.9 JTD	AR 32302	99 - 01
		147 / 156 1.9 JTD	937 A2000	01 ->
		156 / 166 2.4 JTD	839 A6000	00 ->
UC21A	RENAULT	CLIO II 1.9 D	F8Q 630	98 ->
UC22A	FORD	FOCUS 1.8 TDCi	Duratorq TDCi	98 ->
		MONDEO 1.8 TDCi	C9DC	98 ->
UC23A	HYUNDAI	GALLOPER 2.5 TD	INTERCOOLER D4BH	98 ->
		H-1 2.5 TD	D4BF / H	97 ->
		H-100 2.5 TD	D4BF	94 - 00
	NISSAN	PATHFINDER 2.5 D	TD25	93 - 02
		PATHFINDER 2.7 TD	TD27ETi	97 ->
		PATROL 2.7 D	TD27	93 - 02
		PATROL 4.2 TD	TD42	92 - 98
		PICK UP 2.5 D	TD25	89 - 98
		PICK UP 2.7 D	TD27	87 - 98
		TERRANO II	TD27ETi	93 - 02
UC24A	CHEVROLET	BLAZER 2.5 TD	MAXION 4A	93 - 00
		BLAZER 2.8	MWM 4.07 TCA	00 - 05
		S 10 2.5 TD	MAXION ROVER HST 2.5TD	99 ->
		S 10 2.8	MWM 4.07 TCA	00 - 05
	FORD	F-100 2.5 TD	MAXION	98 ->
		RANGER D/C 2.5 TDi	Maxion HS TD 4B	98 - 02
		RANGER S/C 2.5 TDi	Maxion HS TD 4B	97 - 02
	LAND ROVER	DEFENDER 90 2.5 TDi	200/300 TDI	90 ->
		DISCOVERY 2.5 TDi	12L / 21 L	89 - 94
		DISCOVERY 2.5 TDi	19 L	95 ->
	M. BENZ	SPRINTER 2.5 TD	MAXION ROVER HST 2.5TD	95 - 00
	NISSAN	X-Terra 2.8 TDi	MWM 4.07 TCA	03 - 09
	UC26A	BMW	320 2.0D	M47D20
530 3.0 D			M57D30	98 ->
X5 3.0 D			M57D 30-30 6D1	01 - 03
LAND ROVER		FREELANDER 2.0 TD4	M47D20	00 ->
		RANGE ROVER 3.0 TD	M57D30	02 ->
ROVER		75 2.0 TDi	M47D20	99 ->

			<b>MOTOR</b>	
<b>UC27A</b>	FORD	MONDEO 2.0 TDCi	Duratorq TDCi	01 - 05
		MONDEO 2.2 TDCi	Duratorq TDCi	03 - 07
		TRANSIT 2.4 Di	D4FA	00 - 06
JAGUAR	X-TYPE 2.0 D	FMBA, FMBB, R4X404	03 - 09	
<b>UC29A</b>	RENAULT	MASTER 2.5 DCi 120	G9U 724	01 ->
<b>UC2A</b>	FIAT	DUCATO 2.8 D	8140 63	97 ->
	PEUGEOT	BOXER 2.8 D	F.28D	99 - 04
<b>UC30A</b>	RENAULT	CLIO II 1.9 D	F8Q 632	99 ->
		KANGOO 1.9 D	F8Q 632	99 ->
		MEGANE 1.9 D	F8Q 622 / 790	99 ->
<b>UC31A</b>	AUDI	100 AVANT 2.5 TDi	AAT-ABP	90 - 94
		80 AVANT 1.9 TDi	AAZ	91 - 96
		A3 1.9 TDi	AGR-ALH-AHF-ASV-ATD	96 ->
		A4 1.9 TDi	AHH-AHU-AFF-AWX	96 ->
		A6 1.9 TDi	AHU-AFN-AJM	94 ->
		A6 2.5 TDi	AEL	94 - 97
	RENAULT	CLIO II 1.5DCi	K9K 700 / 704 / 702	01 ->
		KANGOO 1.5 DCi	K9K 700 / 704 / 702	01 ->
		KANGOO 1.9 TDi	F9Q 780	00 ->
		LAGUNA 1.9 DCi	F9Q 718 / 750 / 756	99 ->
		LAGUNA 1.9 TD	F9Q 751	03 ->
		LAGUNA 1.9 TDi	F9Q 710	97 - 01
		MEGANE 1.9 DCi	F9Q 732 / 733	01 ->
		MEGANE 1.9 TDi	F9Q 744 / 736	01 ->
		MEGANE II 1.5DCi	K9K 728	02 ->
		MEGANE II 1.9 DCi	K9K 722	02 ->
	SEAT	CORDOBA 1.9 SDi	AEF / AEY	96 - 99
		CORDOBA 1.9 TDi	AGR / ALH	96 - 99
		IBIZA 1.9 TDi	AGR / ALH	96 - 99
		LEON 1.9 TDi	ARL	01 ->
		TOLEDO 1.9 TDi	ARL	99 ->
VOLKSWAGEN	BORA 1.9 TDi	AGP/AQM/AGR/ALH/AHF/ASV	98 - 01	
	CADDY 1.9 Sd	AEY	95 ->	
	GOL 1.9 Sd	EA086 1.9SD BGG	93 ->	

MAGNETI MARELLI		MOTOR		
<b>UC31A</b>	VOLKSWAGEN	GOLF III 1.9 Sd	AEY	97 - 99
		GOLF III 1.9 TDi	1Z / AHU/ ALE / AFN	95 - 98
		GOLF IV 1.9 TDi	AGP/ AQM/ AGR/ ALH/ AHF/ ASV	98 - 01
		PASSAT 1.9 TDi	AGP/ AQM/ AGR/ ALH/ AHF/ ASV	98 - 01
		POLO 1.9 SD	1Y / AEY	96 ->
		POLO 1.9 TDi	AFN / ASV	96 ->
		SHARAN 1.9 TDi	AGP/ AQM/ AGR/ ALH/ AHF/ ASV	98 - 01
<b>UC33A</b>	HYUNDAI	ACCENT 1.5 CRDi	D3EA	02 - 05
		ELANTRA 2.0 CDRi	D4EA	01 - 06
		SANTA FE 2.0 CDRi	D4EA	01 - 06
		TRAJET 2.0 CDRi	D4EA	01 - 06
		TUCSON 2.0 CDRi	D4EA	04 - 08
<b>UC35A</b>	TOYOTA	HI LUX II Pick Up 2.5 D-4D	2KD-FTV	01 ->
<b>UC36A</b>	NISSAN	PATHFINDER 2.7 D	TD27	93 - 02
<b>UC37A</b>	IVECO	DAILY 2.8 TD		98 ->
	RENAULT	MASTER 2.8 TDi	SOFIN	97 ->
<b>UC38A</b>	TOYOTA	COROLLA 2.0	2C	92 - 97
			2C-E	97 - 00
<b>UC40A</b>	CITROËN	JUMPER 2.5 TDi	DJ5TED	96 ->
	PEUGEOT	BOXER 2.5 TDi	DJ5TED	96 ->
<b>UC49A</b>	TOYOTA	SW4 3.0T		96 - 04
<b>UC4A</b>	FIAT	MAREA / BRAVA 1.9 TD	182 A 7000	98 ->
<b>UC53A</b>	TOYOTA	HI LUX III Pick Up 3.0 D	1KD-FTV	06->
		HI LUX III Pick Up 3.0 D-4D 4x4	1KD-FTV	07->
		SW4 3.0 D-4D 4x4	1KD-FTV	
<b>UC5A</b>	TOYOTA	DYNA	2.0/3.0	88- 95
		HI LUX 2.8 D, 4WD	3L	95 - 98
		HI LUX II Pick Up 2.4 D	2L	88 - 97
<b>UC82A</b>	FORD	RANGER 2.2 - 3.2 TDCi	GBVAJPF / GBVAJQW	11->
		RANGER 2.2 - 3.2 TDCi 4x4	GBVAJPF / GBVAJQJ	11->
		RANGER 2.2 Tdci PUMA		08.12->
		RANGER 3.2 Tdci PUMA		06.12->
		TRANSIT 2.2 Tdci PUMA		08.12->



			<b>MOTOR</b>	
<b>UC8A</b>	LAND ROVER	FREELANDER 2.0 Di		98 ->
	RENAULT	LAGUNA 1.9 TDi	F9Q 716	97 - 01
		LAGUNA 2.2 D	G8T 706 / 752 / 790	93 - 01
		LAGUNA 2.2 TD	G8T 760	96 - 01
		MEGANE 1.9 TDi	F9Q 730 / 734	97 - 01
	ROVER	220 2.0	20T2R / 20T2N	95 - 00
		25 2.0 TDi		99 ->
		420 2.0	20T2R / 20T2N	95 - 00
		45 2.0 TDi		00 ->
		620 2.0	20T2N	94 - 99
<b>UC9A</b>	CHEVROLET	ASTRA 1.7 TD	TC4EE1	91 - 96
<b>UX11A</b>	FORD	ESCORT 1.8 D	ENDURA-DE 1.8L RFD / RFK	95 - 99
		MONDEO 1.8 TD	RFN - Endura EURO 1	93 ->
	LADA	ALEKO 1.8 D	RTE, RTS (FORD)	90 ->
	RENAULT	MASTER 2.5 TD	S8V 770	98 - 01
		TRAFIC 2.5 D	SV8 750	97 - 01
<b>UX12A</b>	FIAT	DUCATO 2.5 D	8144 77	94 - 02
<b>UX13A</b>	MERCEDES BENZ	180		91 ->
		100 2.4 D	OM 616.963 / 616.9	88 - 96
		190 2.0D - 2.5 D	OM 601.911 / OM 602.911	89 - 93
		300 3.0	OM 603.971	92 - 93
		C200 2.0	OM 601.913	93 - 00
		E200 2.0D - 2.5 TD	OM 612.912 / OM 602.962	93 - 95
		S350 3.5 TD	OM 603.971	93 - 98
		SPRINTER 2.3 D		95 - 00
		VIANO 2.3 D - TD	OM 601.942	96 - 99
		VITO 2.3D - TD	OM 611.970	99 - 02
	SSANGYONG	KORANDO 2.3 - 2.9		95 ->
		MUSSO 2.3 - 2.9		95 ->
<b>UX14A</b>	JEEP	CHEROKEE 2.1 TD	J8S	89 - 94
	RENAULT	CLIO 1.9 D	F8Q 730 / 732	91 - 98
			F8Q 678	97 - 98

MAGNETI MARELLI		MOTOR		
UX16A	MERCEDES BENZ	C220 2.0	OM 604.910	96 - 00
		C250 2.5 D	OM 605.910	93 - 00
		E250 2.5 D	OM 605.911	93 - 95
		E300 3.0 D	OM 606.910	93 - 95
UX17A	MERCEDES BENZ	C200 / C220 2.0	OM 604.915	96 - 00
		C250 2.5 D	OM 605.910	93 - 00
		E200 2.0 D	OM 604.917	96 - 02
		E220 2.2 CDi	OM 611.960 / 611.961	99 ->
		E270 2.7 CDi	OM 647.961	02 ->
		E320 3.2 CDi		02 ->
		E400 4.0 CDi		03 ->
UX18A	RENAULT	MEGANE 1.9 TD	F8Q 784 / 786	96 ->
		SCENIC 1.9 TD	F8Q 784 / 786	97 - 99
UX19A	FORD	COURIER 1.8D	ENDURANCE	98 ->
		ESCORT 1.8 TD	RVA	95 - 99
		FIESTA 1.8 D	ENDURA-DE 1.8L (RTC/RTD)	95 - 00
		MONDEO 1.8 TD	EURO 2	93 ->
UX20A	ALFA ROMEO	145 / 146 / 155 2.0 JTD	AR 67501	94 - 95
		145 / 146 1.9 JTD	AR 33601-AR 67500	94 - 99
		155 / 164 2.5 TD	VM 07 B-VM 31 B	93 - 95
	ARO	10.1 / 10.4 1.9 D	Renault F8Q 248	86 - 91
		240 / 244 / 246 2.5 TD	Peugeot XD 3P/TP	83 - 93
	BMW	318 2.4 TDS	M41D18	95 ->
		325 2.5 TDS	M51D25	91 - 98
		524 2.4 TDi	M21D24	88 ->
		525 2.5 TDS	M51D25	91 ->
	CITROËN	BERLINGO 1.9 D	D9B - DJI	98 ->
		BX 1.9 D	D9B	88 - 95
		C15 1.8 D	XUD7	86 - 97
		JUMPER 1.9 D	D9B	98 ->
		XANTIA 1.9 TDi	D8B	95 ->
XSARA 1.9 D		DJY	98 - 02	
XSARA 1.9 TDi		DHY	98 - 02	
ZX 1.9 D - TDi	XUD9TE (D8A)	94 - 98		



<b>UX20A</b>	FIAT	147 SPAZIO 1.3 D	146 B 000	86 - 97
		DUCATO 1.9 D	DJY	94 - 98
		DUCATO 1.9 TD	230 A 4000	94 - 02
		DUNA / UNO / FIORINO 1.3 D	146 B 000	88 - 97
		DUNA / UNO / FIORINO 1.7 D	146 B 2000	91 - 01
		PALIO / SIENA / STRADA 1.7 TD	176 A 3000	96 ->
		TIPO 1.9 D - TD	160A7000 / 160D1000	92 - 96
	IVECO	DAILY 2.4 D	SOFIN 8140.61	83 - 89
	JEEP	CHEROKEE 2.1 TD	J8S 814-890	91 - 95
		CHEROKEE 2.5 TD	VM HR 425 C LIRX	88 - 95
	LADA	NIVA 1.9 D	XUD9A (PEUGEOT)	93 ->
		NIVA 1.9 D	XUD9SD (PEUGEOT)	99 ->
	LAND ROVER	RANGE ROVER 2.5 D	14L / 25 6T	94 - 02
	MERCEDES BENZ	190 2.5 D - TD	OM 602.911 / OM 602.961	85 - 89
		200 2.0	OM615.940 / OM 615.912	80 - 89
		240 2.4 D	OM 616.912	80 - 85
		300 3.0	OM 617A	77 - 87
		SPRINTER 2.9	OM 602.980	95 - 00
	PEUGEOT	205 1.9 D	XUD9	87 ->
		306 1.8 - 1.9 D	XUD7	98 ->
		306 1.9 TD	D8B XUD9 A/L	93 - 00
		405 1.9 D	XUD9A / Y	88 ->
		406 2.1 TD	XUD11ATE	95 - 98
		504 2.3	XD4.88 / XD2	83 ->
		505 2.3	XD2	81 ->
		505 2.5	XD3-T	81 ->
		BOXER 1.9 D - TD	XUD9AU (DB9)	94 ->
		BOXER 2.5 D	DJ5 (T9A)	94 ->
		EXPERT 1.9 D	XUD9AU	96 - 02
		PARTNER 1.9 D	XUD9AU	96 ->
		RENAULT	18 2.1 D	J8S / J8S 712
	19 1.9 D		F8Q	94 - 98
	21 2.1		J8S	91 - 94
	TRAFIC 2.1 D			89 - 97
	SUZUKI	VITARA 1.9 D	XUD9A	95 - 98



<b>UX22A</b>	RENAULT	CLIO 1.9 D	F8Q 676 / 678 / 696	91 - 98
		EXPRESS 1.9 D	F8Q 640 / 682	96 ->
		MEGANE 1.9 D	F8Q 620 / 624	96 ->
	RENAULT	SCENIC 1.9 D	F8Q 620	97 - 99
<b>UX23A</b>	M. BENZ	SPRINTER 2.9	OM 602.980	95 - 00
<b>UX27A</b>	AUDI	A3 1.9 TDi	ALH + ASV	97 - 01
		A4 1.9 TDi / Quattro	AJM	98 - 00
	SEAT	CORDOBA 1.9 TDi	ALH + 1Z + ALH	96 - 01
		IBIZA 1.9 TDi	AGR	99 - 02
		LEON 1.9 TDi	ALH + ASV	99 - 04
		TOLEDO 1.9 TDi	AGR + ASV	99 - 03
	VOLKSWAGEN	BORA 1.9 TDi	D5252T	98 - 05
		GOLF IV 1.9 TDi	D5252T	01 - 07
		NEW BEETLE 1.9 TDi	D4192T3	00 - 05
		PASSAT 1.9 TDi / VARIANT	D5252T	93 - 05
	VOLVO	850 TDi	D5252T	96 - 97
		S70 TDi	D5252T	97 - 00
		V40 1.9 D	D4192T3	00 - 04
V70 I 2.5TDi		D5252T	97 - 00	
<b>UX32A</b>	DEUTZ	DEUTZ F6L714 - FA(2/3/4/6) L (514/614/714/716/812)	Lápiz largo	
	IME	RASTROJERO Bordward 52HP / Indenor 2.0 4.88	Lápiz largo	
	PEUGEOT	404D 1.9	INDENOR / XD4.88	76 - 78
		504 GL / GRD / SRD 1.9 / 2.1 / 2.3	XD2 / X4.88 / X4.90	70 - 78
		504 Indenor	75 ->	
<b>UX33A</b>	DEUTZ	DEUTZ F(2/3/4/6/8/12) L (514/614/714/716)	Lápiz corto	
	IME	RASTROJERO Bordward 42HP	Lápiz Corto	
<b>UX7A</b>	BORDWARD	VM	VM	
	LAND ROVER	RANGE ROVER 2.4 D	11A	86 - 90
<b>UX8A</b>	SEAT	CORDOBA 1.9 D	1Y	93 - 96
		INCA 1.9 D	1Y	93 - 96
	VOLKSWAGEN	BORA 1.9 TDi	AGP/AQM/AGR/ALH/AHF/ASV	98 - 01
		GOL 1.6	AP 1.6D BE	93 ->
		GOL 1.9 D - TD	EA086 1.9SD 1Y	93 ->
		GOLF III 1.9 G TD	AAZ	91 - 99
GOLF IV 1.9 TDi	AGP/AQM/AGR/ALH/AHF/ASV	98 - 01		

			<b>MOTOR</b>	
<b>UX8A</b>	VOLKSWAGEN	PASSAT 1.9 TDi	AGP/AQM/AGR/ALH/AHF/ASV	98 - 01
		SAVEIRO 1.6	AP 1.67D BE	93 ->
		SAVEIRO 1.9 D - TD	EA086 1.9SD 1Y	93 ->
		SENDA 1.6	AP 1.6D BE	93 ->
		SHARAN 1.9 TDi	AGP/AQM/AGR/ALH/AHF/ASV	98 - 01
<b>UY1A</b>	CITROËN	C3 1.4 HDi	8HX	02 ->
		ECOSPORT 1.4 TDCi	F6JA / F6JB	02 ->
	FORD	FIESTA 1.4 TDCi	F6JA / F6JB	01 ->
		FOCUS 2.0 TDCi	Duratorq TDCi	03 ->
	PEUGEOT	206 1.4 HDi	DV4TD (8HX)	01 ->
<b>UY2A</b>	CHEVROLET	COBALT 1.3 TD	Z13DT	02.13 ->
		SPIN 1.3 TD	Z13DT	02.13 ->
	FIAT	500 1.3 MJTD (16V)	169 A1.000	07.18-12.18
		PUNTO 1.3 JTD MULTIJET	188 A9.000, 199 A2.000, 223 A9.000	09.09-12.18
		STRADA 1.3 JTD MULTIJET		10.18 ->
<b>UY5A</b>	CITROËN	BERLINGO 1.6 Hdi	9HZ - DV6TED4	08 ->
		C3 1.4 Hdi	8HW - DV4TD	03 - 12
		C4 1.6 Hdi	9HZ - DV6TED4	07 ->
		Grand C4 Picasso 1.6 Hdi	9HZ - DV6TED4	08 ->
	PEUGEOT	307 1.6 Hdi	DV6TED4 - 9HZ/9HY	06 ->
		307 1.6 Break Hdi SW	DV6TED4 - 9HZ/9HY	06 ->
		3008 1.6 Hdi	DV6TED4 - 9HZ	09 ->
		EXPERT 1.6 Hdi	DV6TED4 - 9HU	07 ->
		PARTNER 1.6 Hdi	DV6TED4 - 9HZ	08 ->
<b>UY6A</b>	FIAT	307 1.6 Hdi	DV6TED4 - 9HZ/9HY	10 ->
<b>UY7A</b>	AUDI	A3 2.0 TDi	CRFA	11.13 ->
		A4 2.0 TDi	CMEA	11.13 ->
		A4 3.0 TDi		11.10 ->
		A5 2.0 TDi	CMEA	12 - 13
		A6 2.7 TDi	BPP	07.08 ->
		A6 3.0 TDi	BMK	07 - 12
		ALLROAD 2.7 Tdi	BPP	01.07 - 02.10
		ALLROAD 3.0 Tdi	CDYC	08.06 - 01.10
		Q3 2.0 Tdi		08.13- >
		Q5 2.0 Tdi	CMBG	09.09 ->

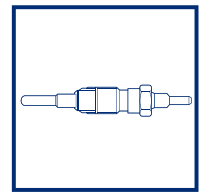

		<b>MOTOR</b>		
<b>UY7A</b>	AUDI	Q5 3.0 Tdi		09.09 ->
		Q7 3.0 Tdi		04.06 ->
	VOLKSWAGEN	AMAROK 2.0 Bi TDi / 4 motion	CDCA	10 ->
		AMAROK 2.0 Bi TDi / 4 Motion	CDBA	10 ->
		AMAROK 2.0 TDi 143CV		12.10->
		AMAROK 2.0 TDi 180CV		12.10->
		CC 2.0 TDi	CBAA	11->
		PASSAT 2.0 Tdi	CBAB	02.06 - 12.11
		PASSAT 2.0 Tdi	CLLA	09.12->
		TIGUAN 2.0 Tdi	CBAB	02.09 ->
		TOUAREG 3.0 Tdi	CASA	11->
<b>UY81A</b>	CHEVROLET	S 10 2.8 CTDi 4X2 / 4X4	MOTOR DURAMAX	12 ->
<b>UY10A</b>	FIAT	TORO 2.0 JTD 4WD	Multijet 16v-EURO 5	02.16 ->
		TORO 2.0 JTD 4X2	Multijet 16v-EURO 5	02.16 ->
		BRAVO 1.6 JTD	198A20006	12.18->
<b>UY11A</b>	CHEVROLET	CAPTIVA 2.0 CDRI	Z20S	06.18 ->
		CRUZE 2.0 CDI	LLW	09.18 ->
<b>UZ1A</b>	CHEVROLET	CORSA 1.7D	ISUZU 4EE1/X17D	95 - 00
<b>UZ1B</b>	CHEVROLET	CORSA 1.7D	ISUZU 4EE1/X17D	97 - 00
<b>UZ2A</b>	CHEVROLET	CORSA 1.7 TD	Y 17DT	00 - 07
		MERIVA 1.7 TD	Y 17DT	03 - 09
<b>UZ2B</b>	CHEVROLET	CORSA 1.7 TD	Y 17DT	00 - 08
		MERIVA 1.7 TD	Y 17DT	03 - 09
<b>UZ4B</b>	MITSUBISHI	L200 2.5 D - TD	4D56	95 ->
		SPACE WAGON 2.0 TD	4D65 SHC	92 - 00
<b>UZ80B</b>	NISSAN	FRONTIER 2.5 Dci	YD25DDTI	10 ->
		FRONTIER 2.5 DCi 4WD	YD25DDTI	10 ->
		FRONTIER 3.0 DCi 4WD	VX9	10 ->
		MURANO 2.5 4x4		10 ->
		PATHFINDER 2.5 DCi 4WD	YD25DDTI	10 ->
		PATHFINDER 3.0 DCi	VX9	10 ->
		X-Trail 2.0 DCi - DCi FWD	M9R / M9R 760	07 ->
	RENAULT	MASTER III Bus 2.3 DCi 125	M9T 670, 672, 676	10 ->

**Bujías de Precalentamiento**  
Imágenes por tamaño



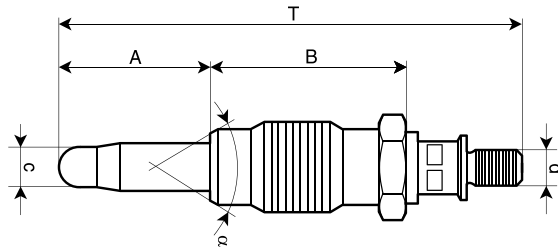



**UX18A**

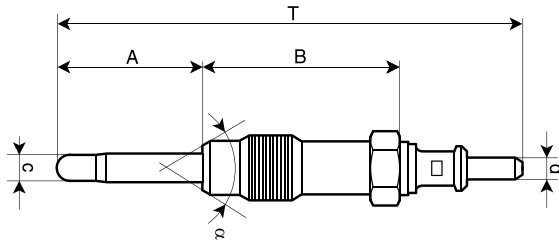

T	61,4
A	20
B	26
c	6,1
d	5
a	63
	M12x1,25
	12
V	11
Amp	10
	7"
Nm	15-22



**UX8A**



T	61,4
A	20
B	26
c	6,1
d	5
a	63
	M12x1,25
	12
V	11
Amp	10
	7"
Nm	15-22

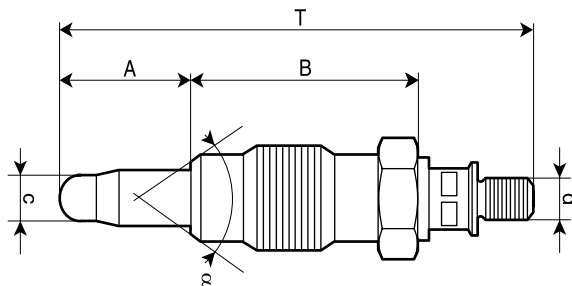

**UX19A**

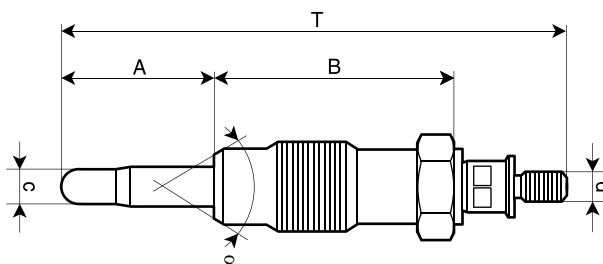

T	62,9
A	17,5
B	30
c	6,1
d	5
a	63
	M12x1,25
	12
V	11
Amp	10
	7"
Nm	15-22

**UX11A**



T	66,9
A	20
B	32
c	5
d	4
a	63
	M12x1,25
	12
V	11
Amp	10
	7"
Nm	15-22

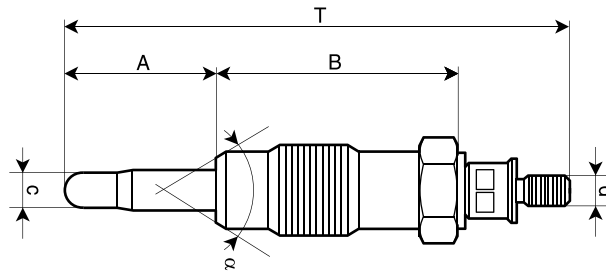

**UX12A**

T	66,9
A	20
B	32
c	5
d	4
a	63
	M12x1,25
	12
V	11
Amp	10
	7"
Nm	15-22

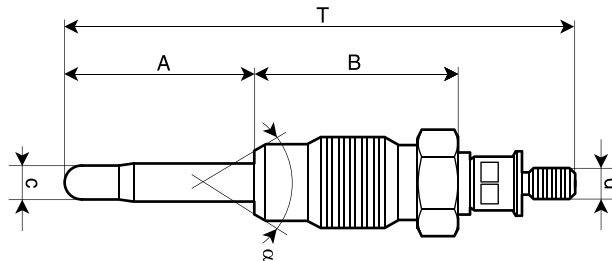
**UX22A**

T	67,4
A	25
B	27
c	5
d	4
a	63
	M12x1,25
	12
V	11
Amp	10
	7"
Nm	15-22

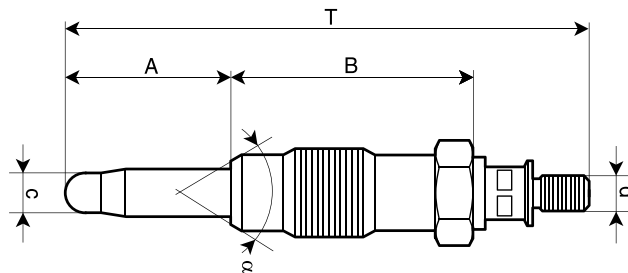
**UX13A**



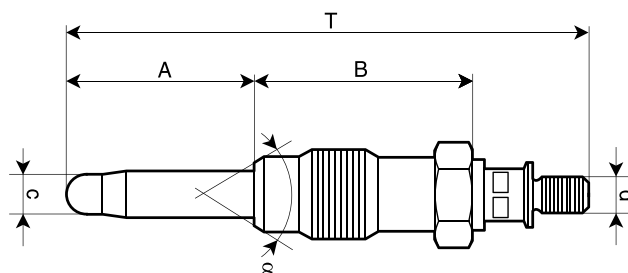

T	69,4
A	22
B	32
c	6,1
d	5
a	63
	M12x1,25
	12
V	11,5
Amp	10
	7"
Nm	15-22

**UX14A**

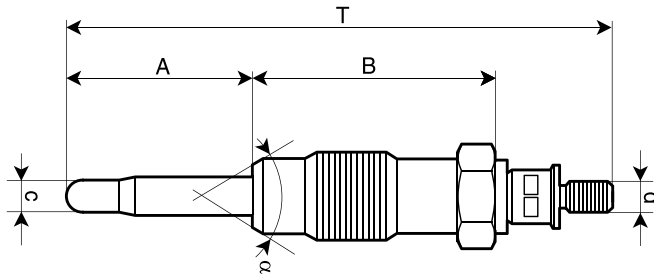
T	69,4
A	25
B	29
c	6,1
d	5
a	63
	M12x1,25
	12
V	11
Amp	10
	7"
Nm	15-22



**UC4A**



T	71,9
A	24,5
B	32
c	5
d	4
a	63
	M12x1,25
	12
V	11
Amp	10
	7"
Nm	15-22

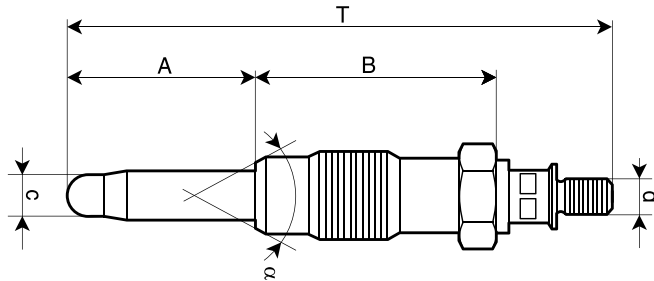

**UX20A**



T	72,4
A	25
B	32
c	6,1
d	5
a	63
	M12x1,25
	12
V	11
Amp	10
	7"
Nm	15-22

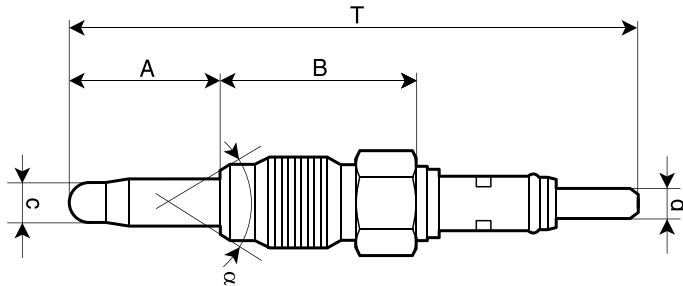

**UX27A**

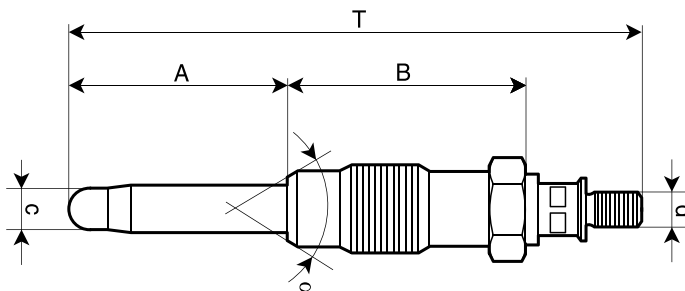

T	75,5
A	20
B	26
c	6,1
d	4
a	63
	M12x1,25
	12
V	12
Amp	10
	7"
Nm	15-22

**UX7A**

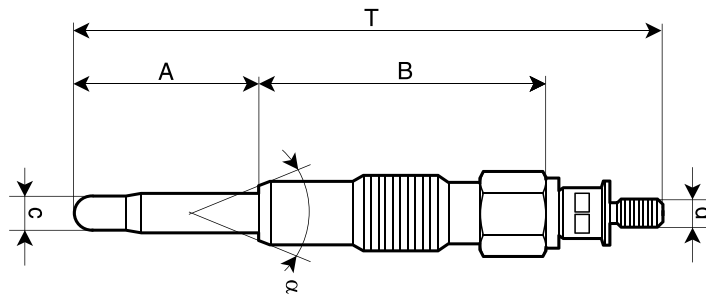

T	76,4
A	29
B	32
c	6,1
d	5
a	63
	M12x1,25
	12
V	11
Amp	10
	7"
Nm	15-22

**UC37A**

T	77,9
A	24,5
B	38
c	5
d	4
α	63
	M10x1
	10
V	11
Amp	10
	7"
Nm	10-15

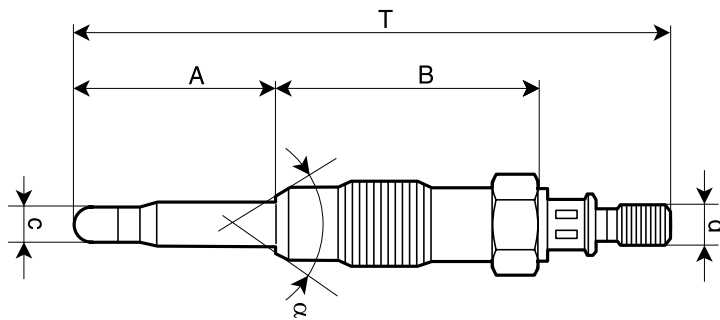
**UX33A**

T	80
A	16
B	47,5
c	6
d	5
α	60
	M18x1,5
	19
V	10,5
Amp	
	7"
Nm	25-30

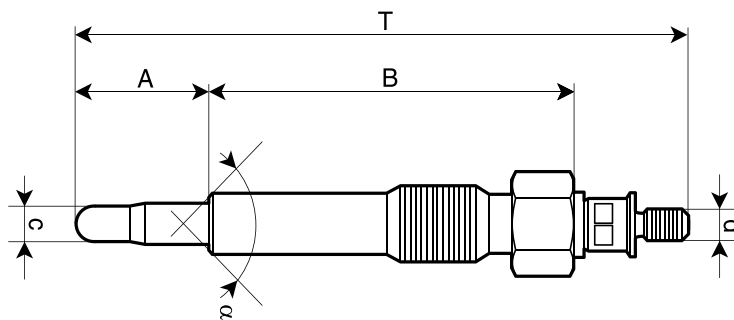
**UC9A**



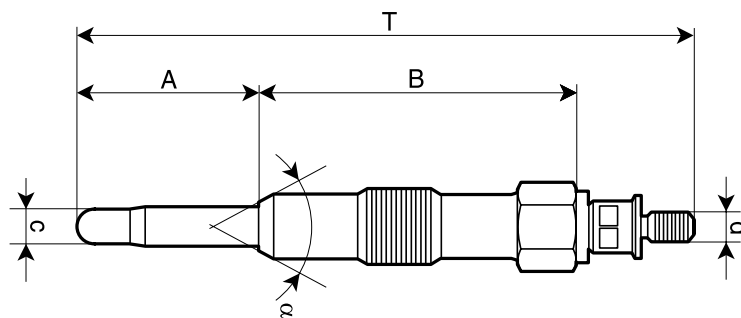

T	80,9
A	17,5
B	48
c	5
d	4
α	118
	M10x1,25
	12
V	11
Amp	10
	7"
Nm	10-18

**UC2A**

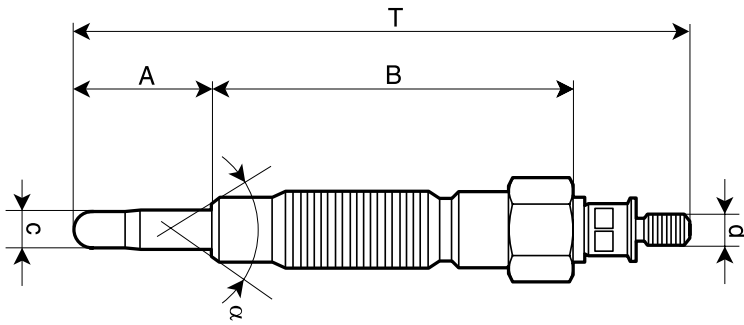
T	81,4
A	24
B	42
c	5
d	4
α	63
	M10x1
	10
V	11
Amp	10
	7"
Nm	10-15



**UZ4B**



T	81,4
A	18,5
B	47,5
c	5
d	4
a	123
	M10x1,25
	12
V	11
Amp	10
	7"
Nm	10-18

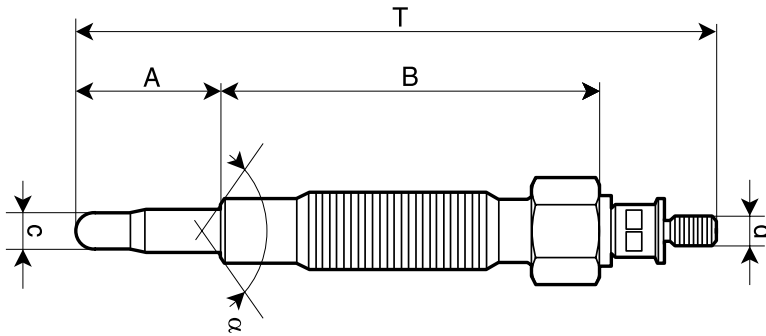

**UC36A**



T	84,4
A	19
B	50
c	5
d	4
a	120
	M10x1,25
	12
V	11
Amp	10
	7"
Nm	10-18

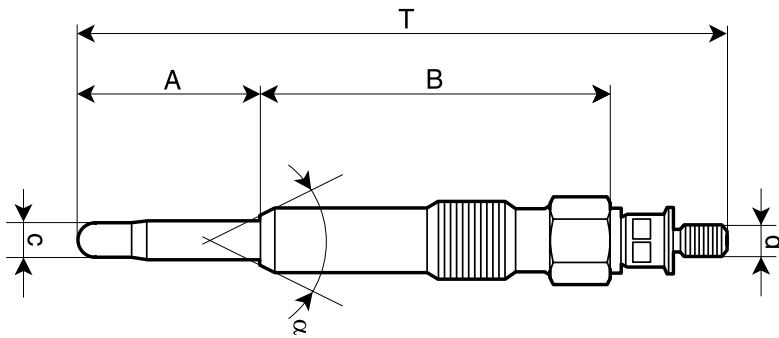

**UC8A**

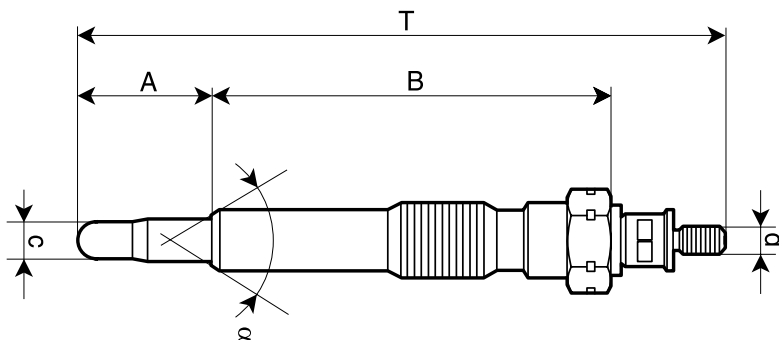

T	85,4
A	24
B	46
c	5
d	4
a	63
	M10x1
	10
V	11
Amp	10
	7"
Nm	10-15

**UZ1B**

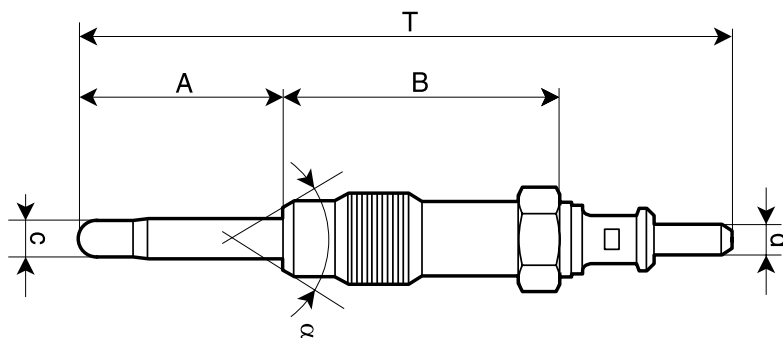

T	85,9
A	17,5
B	53
c	5
d	4
a	90
	M10x1,25
	12
V	11
Amp	10
	7"
Nm	10-18

**UX23A**

T	87
A	27
B	37
c	5
d	4
a	63
	M12x1,25
	12
V	11,5
Amp	10
	7"
Nm	15-22

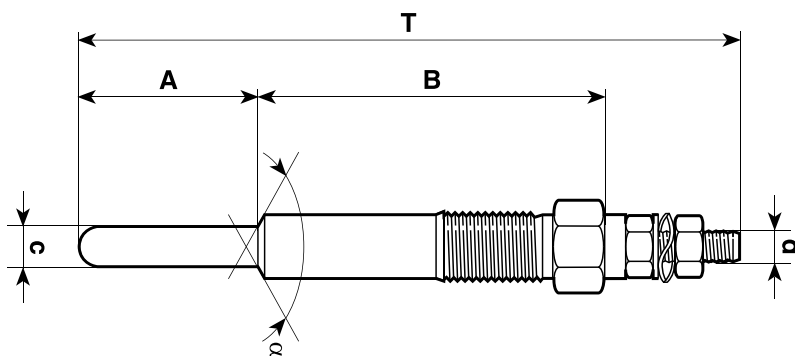
**UC10A**

T	87,4
A	24
B	48
c	5
d	M4
a	118
	M10x1,25
	12
V	11
Amp	10
	7"
Nm	10-18

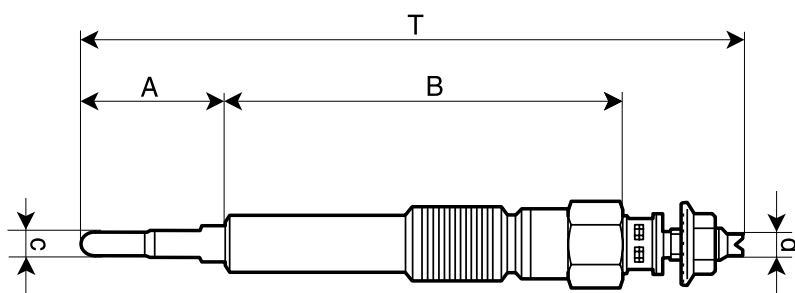
**UZ1A**



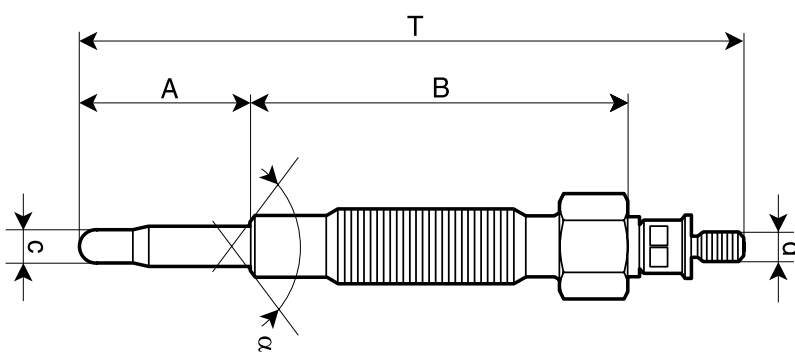

T	87,5
A	18
B	53
c	3,3
d	M4
a	120
	M10x1,25
	12
V	11
Amp	4
	4"
Nm	10-12

**UC23A**

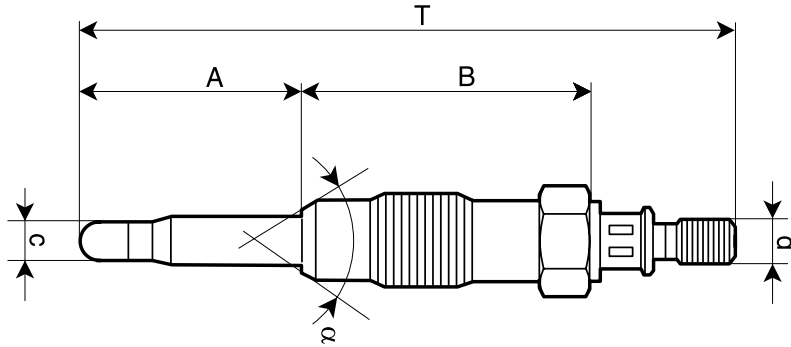
T	87,9
A	22,5
B	50
c	5
d	4
a	120
	M10x1,25
	12
V	11
Amp	10
	7"
Nm	10-18



**UX32A**



T	90
A	25
B	47,5
c	6
d	5
a	60
	M18x1,5
	19
V	10,5
Amp	
	7"
Nm	25-30

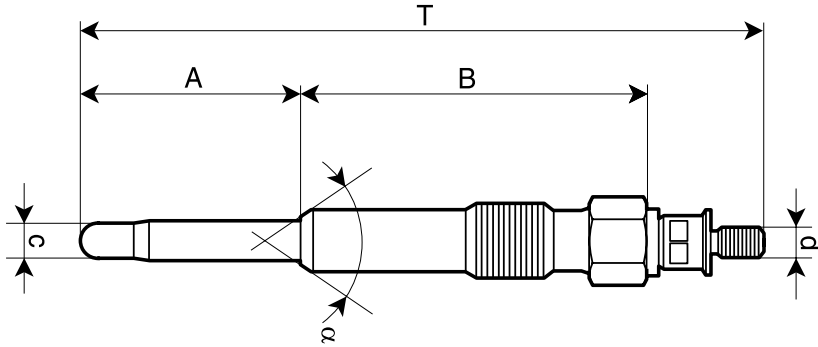

**UC15A**



T	90,4
A	29
B	46
c	5
d	4
a	63
	M10x1
	10
V	11
Amp	10
	7"
Nm	10-15

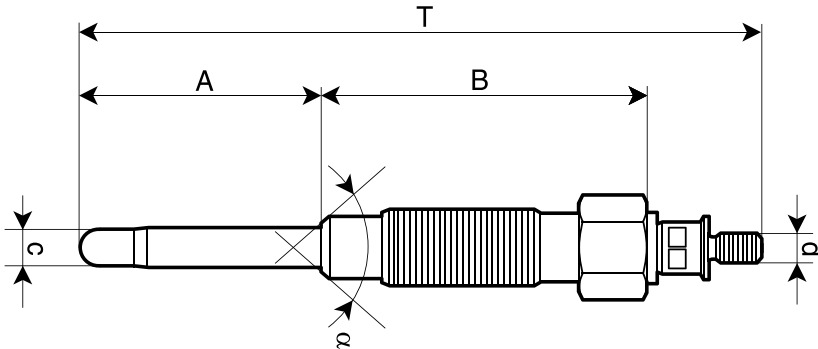

**UC5A**

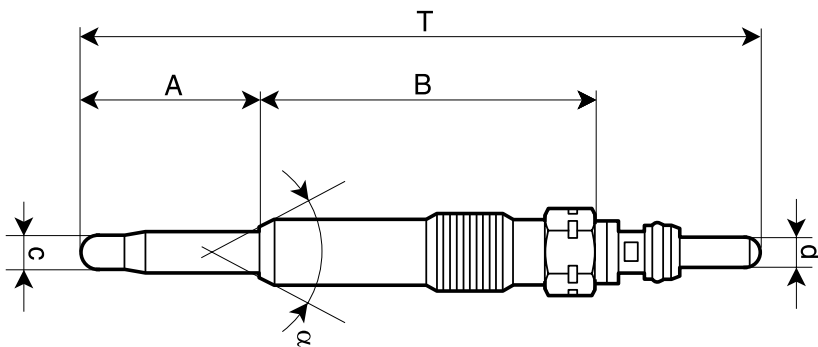

T	90,4
A	32
B	43
c	5
d	4
a	90
	M10x1,25
	12
V	11
Amp	10
	7"
Nm	10-18

**UC53A**

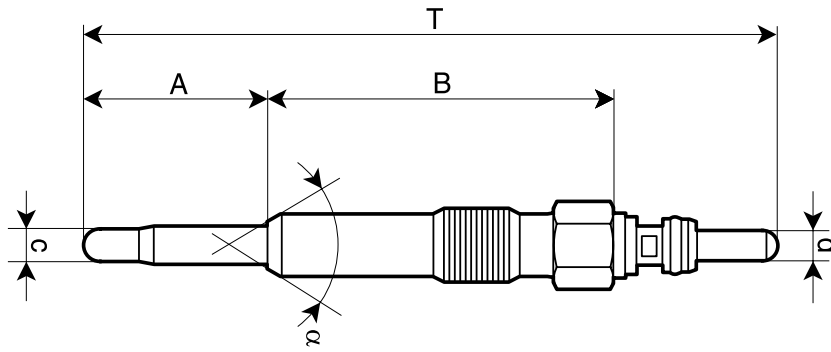

T	90,5
A	24
B	44,5
c	5
d	4
a	63
	M10x1
	10
V	11
Amp	10
	7"
Nm	10-15

**UC31A**

T	92
A	24
B	46
c	5
d	4
α	63
	M10x1
	10
V	11
Amp	10
	7"
Nm	10-15

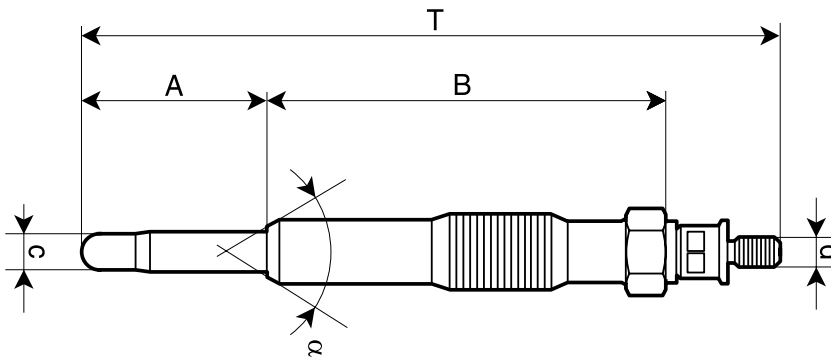
**UC21A**

T	92,9
A	24,5
B	53
c	5
d	4
α	63
	M10x1
	10
V	11
Amp	10
	7"
Nm	10-15

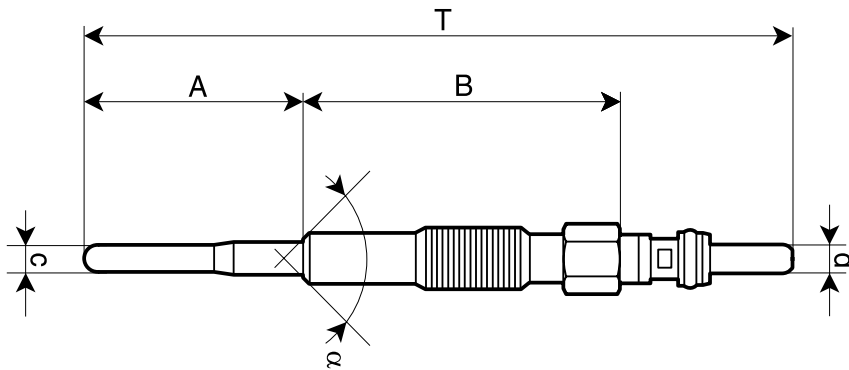
**UY11A**

T	93,9
A	29
B	42
c	4
d	4
α	93
	M8x1
	8
V	4,4
Amp	8,5
	4"
Nm	8-12

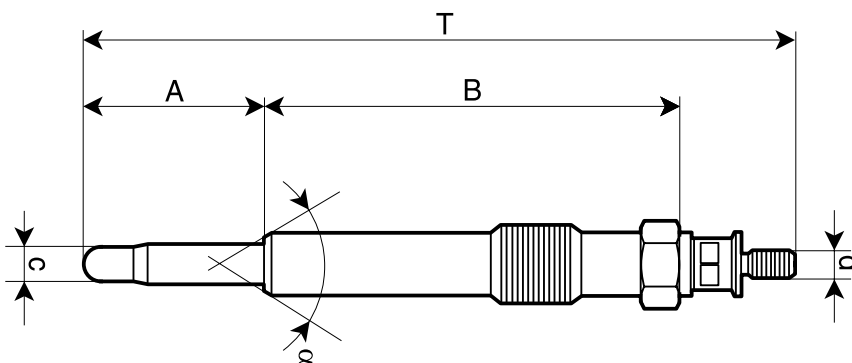
**UC22A**

T	94,9
A	24,5
B	55
c	5
d	4
α	93
	M10x1
	10
V	10
Amp	10
	7"
Nm	10-15

**UC11A**

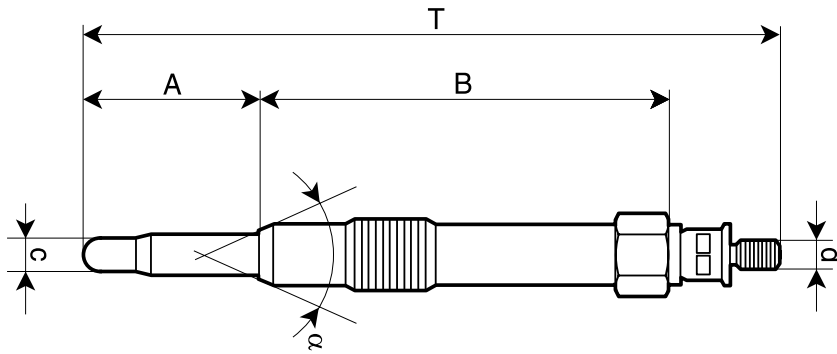

T	96,4
A	24
B	57
c	5
d	4
a	63
	M10x1
	10
V	11
Amp	10
	7"
Nm	10-15

**UC14A**

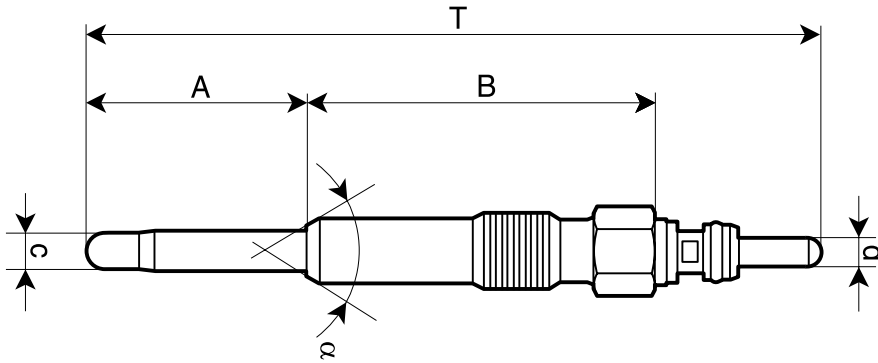

T	97
A	29
B	46
c	5
d	4
a	63
	M10x1
	10
V	11
Amp	10
	7"
Nm	10-15

**UC49A**

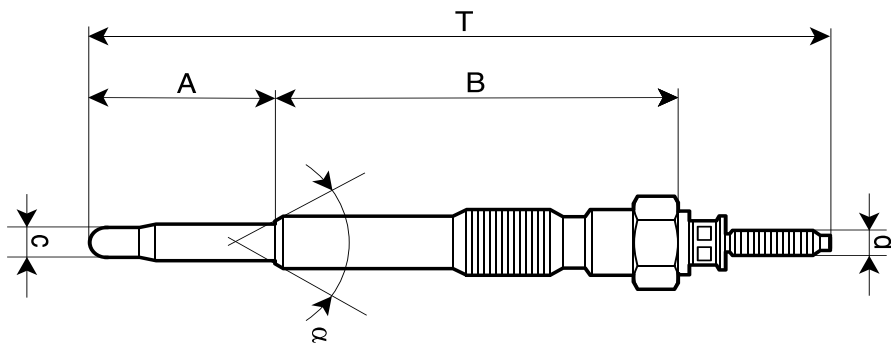

T	98,3
A	25
B	53
c	5
d	4
a	90
	M10x1,25
	12
V	11
Amp	10
	7"
Nm	10-18

**UC38A**

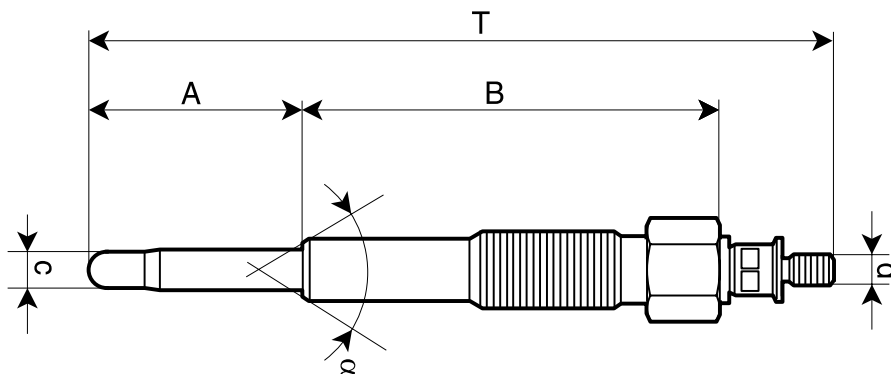

T	98,4
A	28
B	55
c	5
d	4
a	93
	M10x1,25
	12
V	11
Amp	10
	7"
Nm	10-18

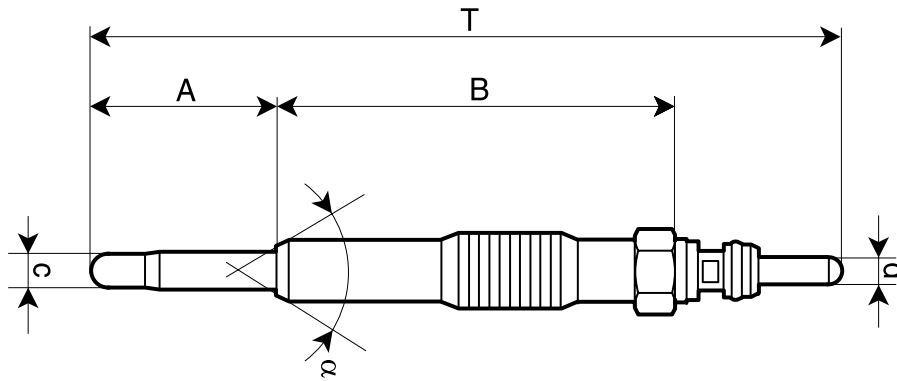

**UC30A**

T	99,2
A	24,5
B	53
c	5
d	4
α	63
	M10x1
	10
V	11
Amp	10
	7"
Nm	10-15

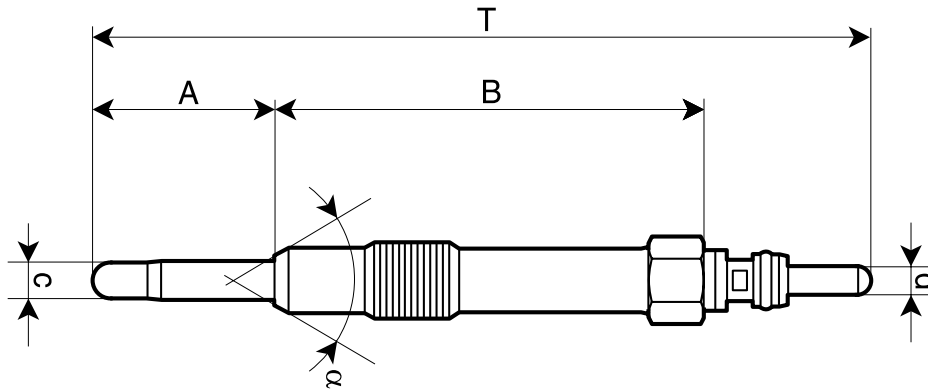
**UC19A**

T	103
A	24
B	47
c	5
d	4
α	63
	M10x1
	10
V	11
Amp	10
	7"
Nm	10-15

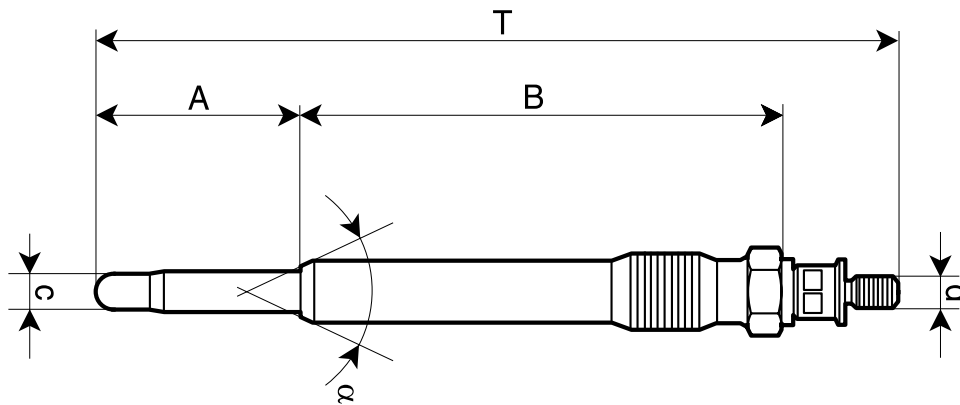
**UC12A**

T	105,9
A	27
B	63,5
c	5
d	4
α	63
	M10x1
	10
V	11
Amp	10
	7"
Nm	10-15

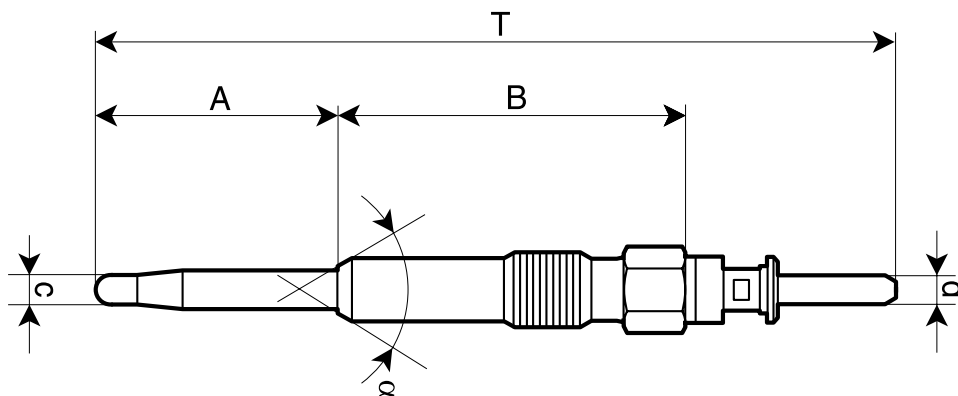
**UC02F**

T	106
A	32
B	46
c	5
d	4
α	63
	M10x1
	10
V	5
Amp	8
	4"
Nm	10-15

**UC26A**

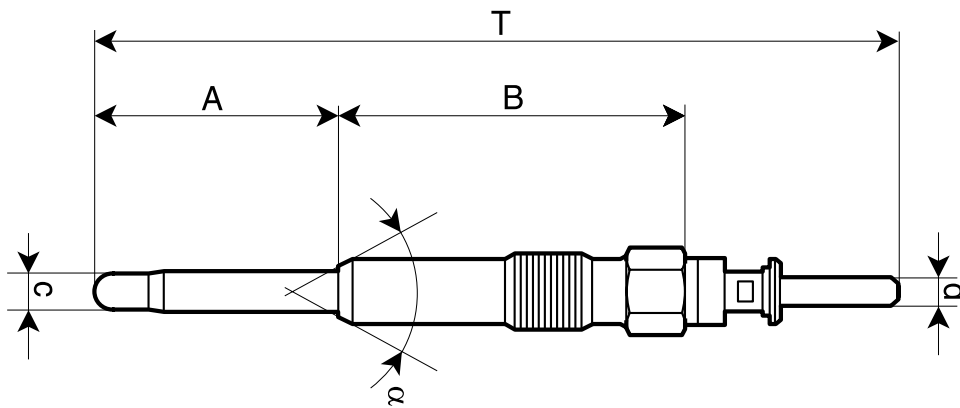

T	106
A	32
B	46
c	5
d	4
a	63
	M10x1
	10
V	11
Amp	10
	7"
Nm	10-15

**UC33A**

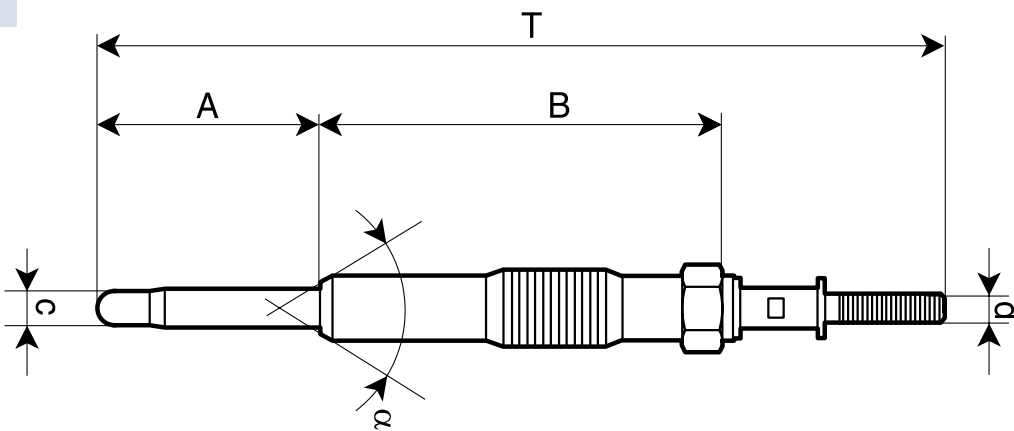

T	112,2
A	29,5
B	53
c	5
d	4
a	63
	M10x1
	10
V	11
Amp	10
	7"
Nm	10-15

**UX17A**

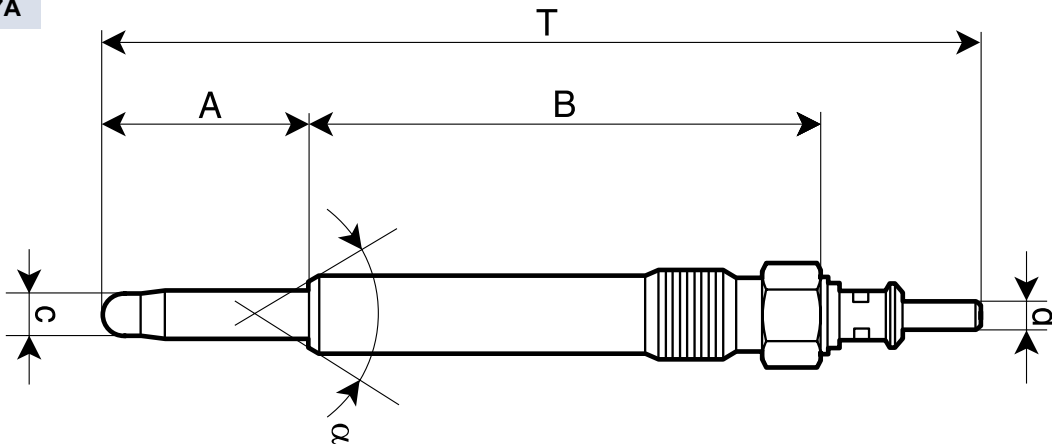

T	115,9
A	27
B	67,5
c	6,1
d	4
a	63
	M12x1,25
	12
V	11,5
Amp	10
	7"
Nm	15-22

**UC40A**

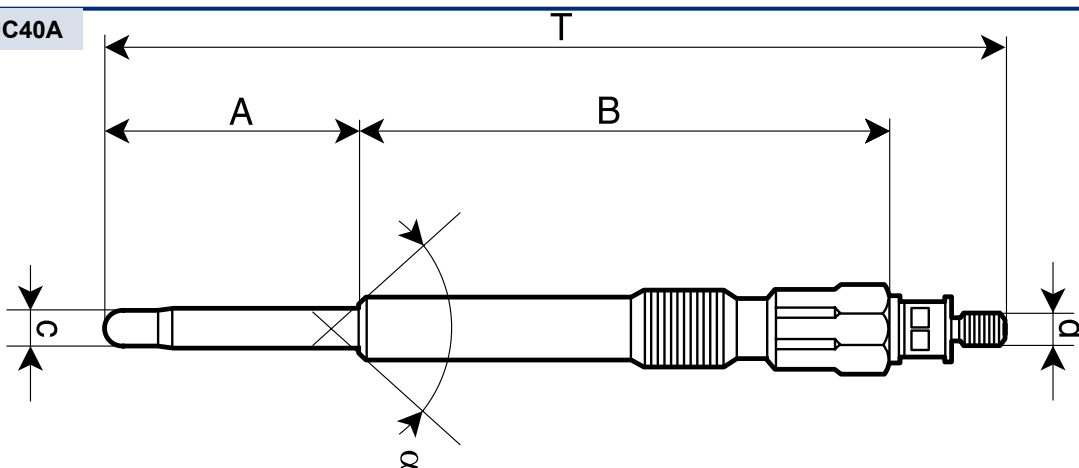

T	118,9
A	33,5
B	70
c	5
d	4
a	93
	M10x1
	10
V	11
Amp	10
	7"
Nm	10-15

UY2A

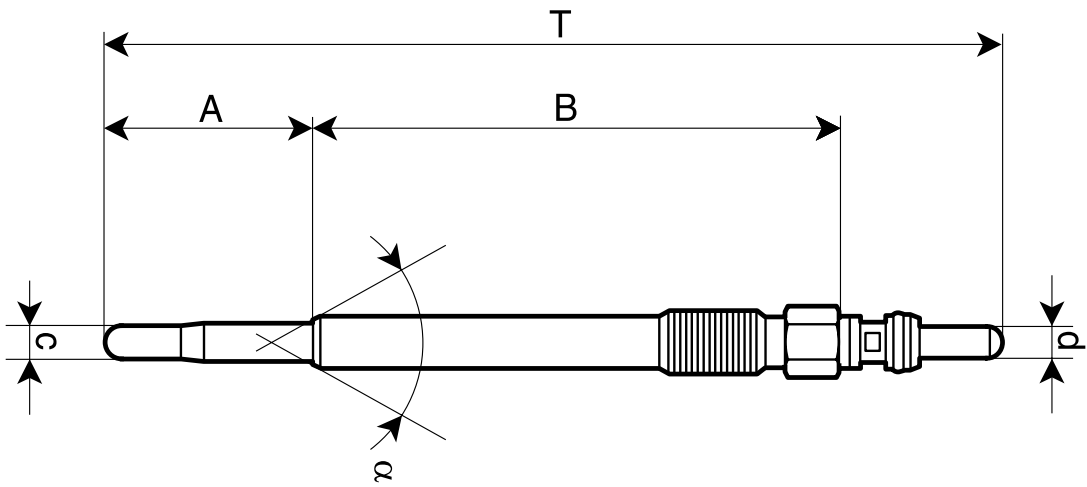

T	118,9		M8x1
A	27,5		8
B	70	V	11
c	4	Amp	10
d	4		3"
alpha	93	Nm	8-12

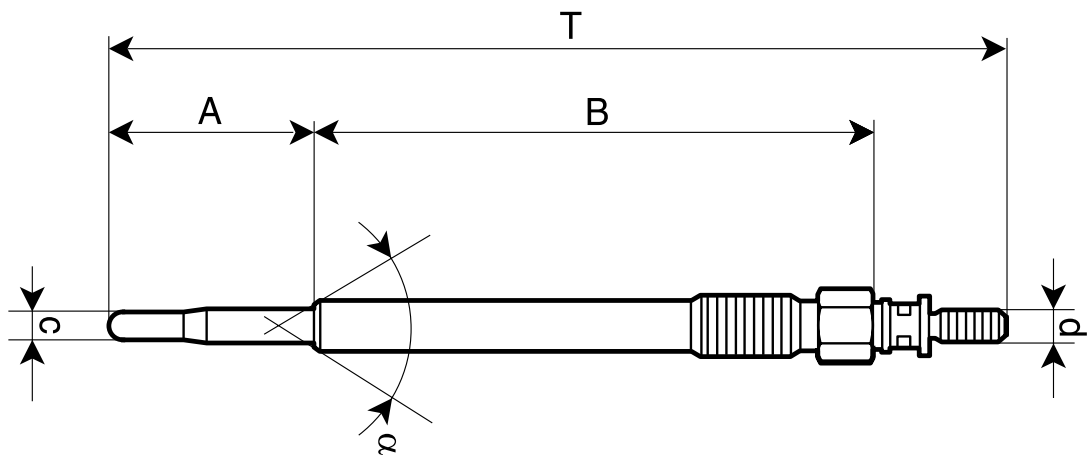

UY1A



T	119,9		M8x1
A	27,5		8
B	75	V	11
c	4	Amp	10
d	4		3"
alpha	93	Nm	8-12

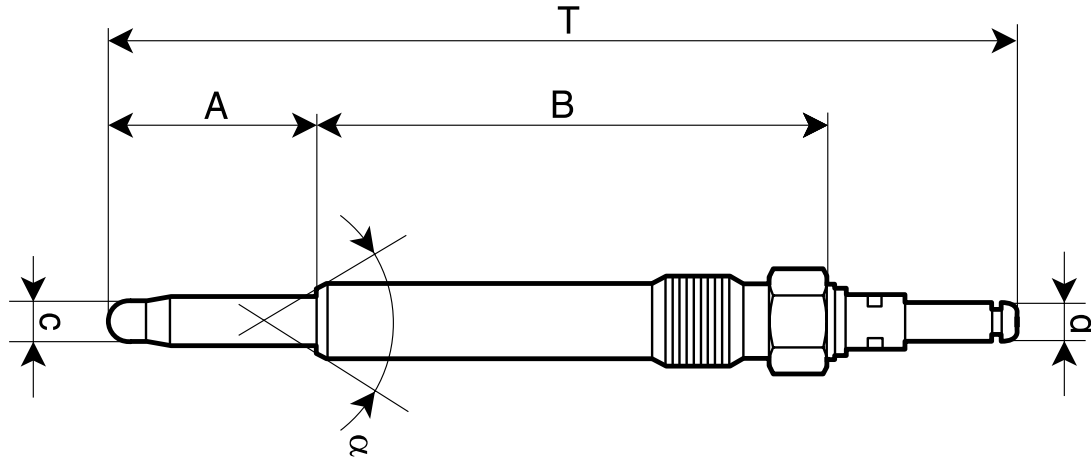

**UX16A**



T	120,4		M12x1,25
A	27,5		12
B	67,5	V	11,5
c	6,1	Amp	10
d	5		7"
a	63	Nm	15-22

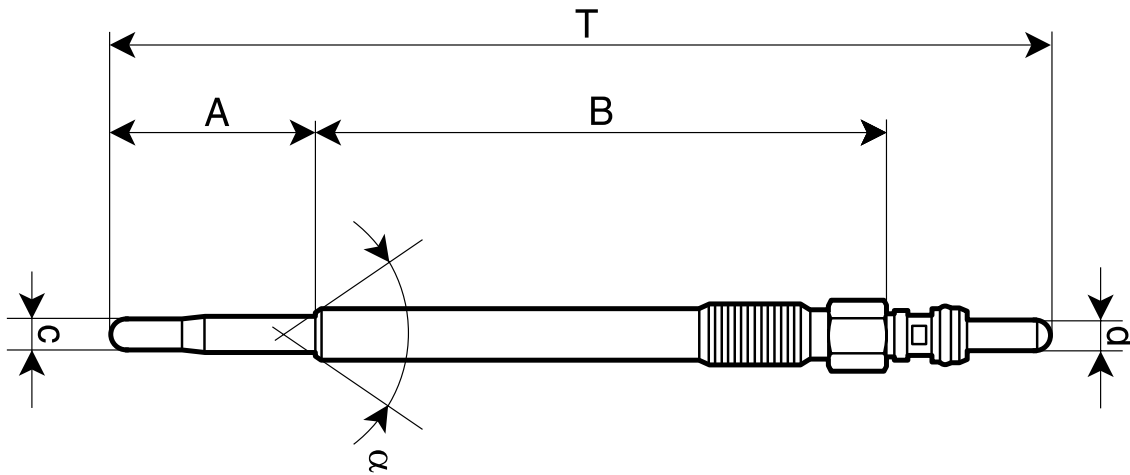

**UY5A**



T	124,1		M8x1
A	27,5		8
B	75	V	11
c	4	Amp	10
d	4		3"
a	93	Nm	8-12

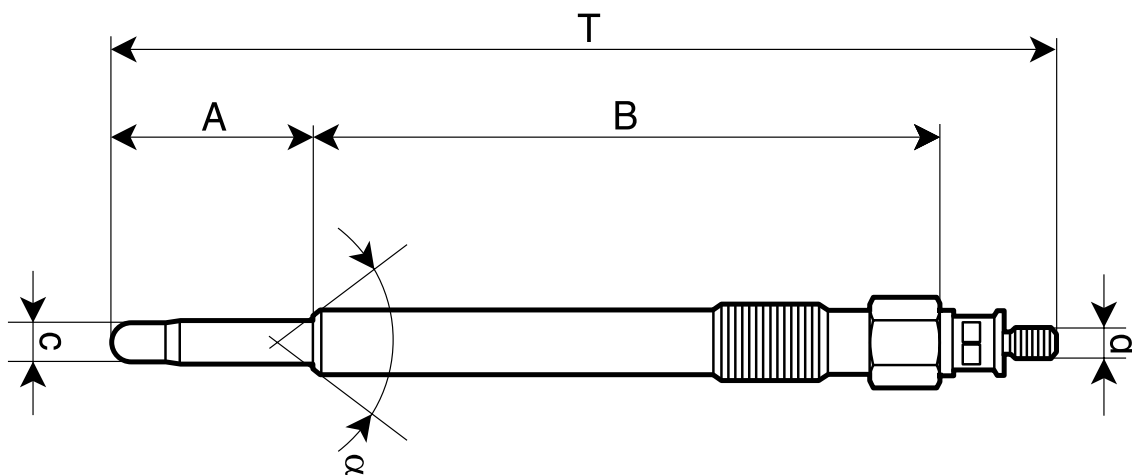

UC24A

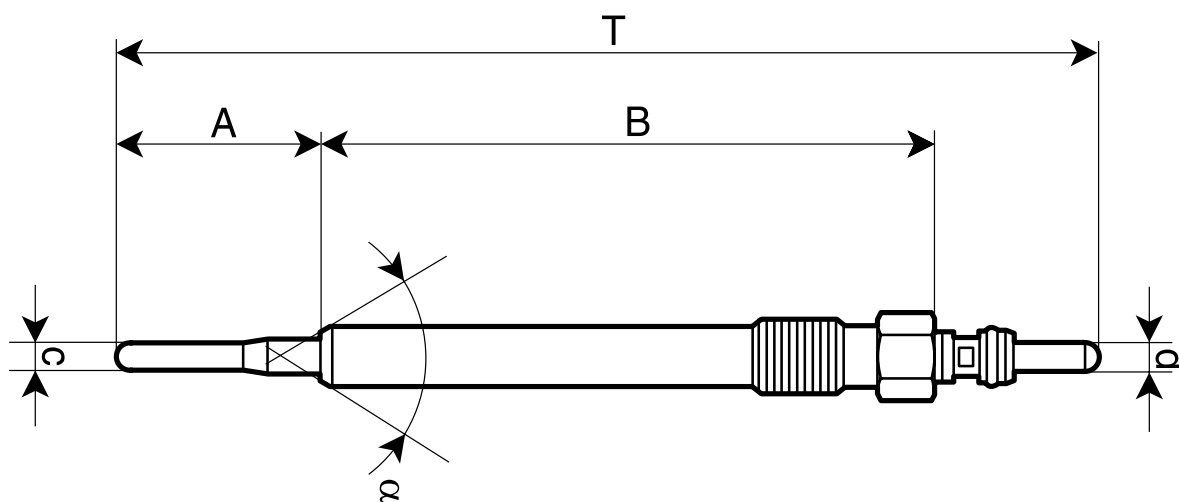

T	124,9		M10x1
A	26,5		10
B	83	V	11,5
c	5	Amp	10
d	4		7"
alpha	90	Nm	10-15

UY7A



T	129,4		M10x1
A	27		10
B	81	V	4,4
c	4	Amp	8
d	4		4"
alpha	63	Nm	10-15

UC17A

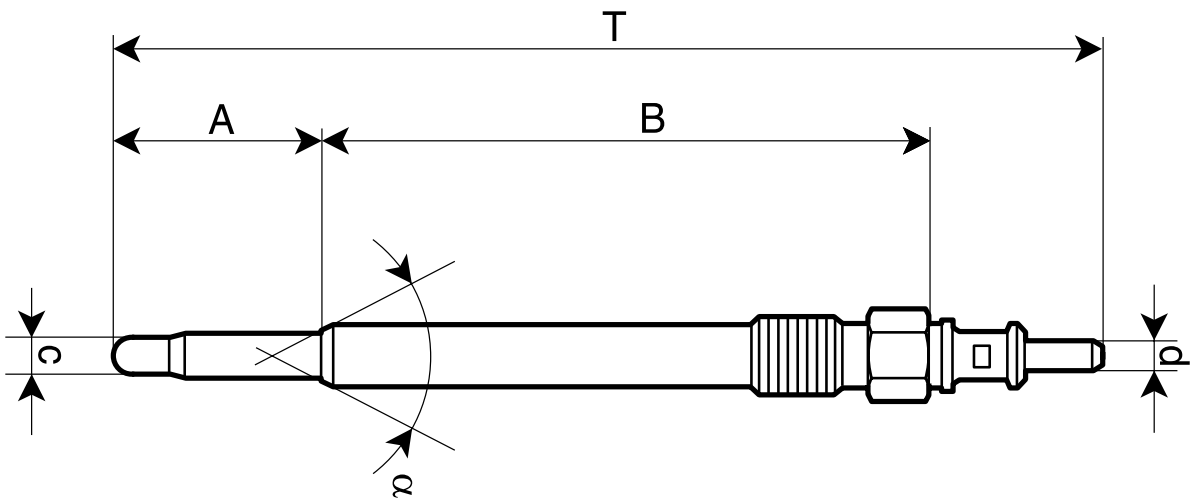

T	130,5		M10x1
A	27		10
B	80,5	V	11,5
c	5	Amp	10
d	4		7"
a	63	Nm	10-15

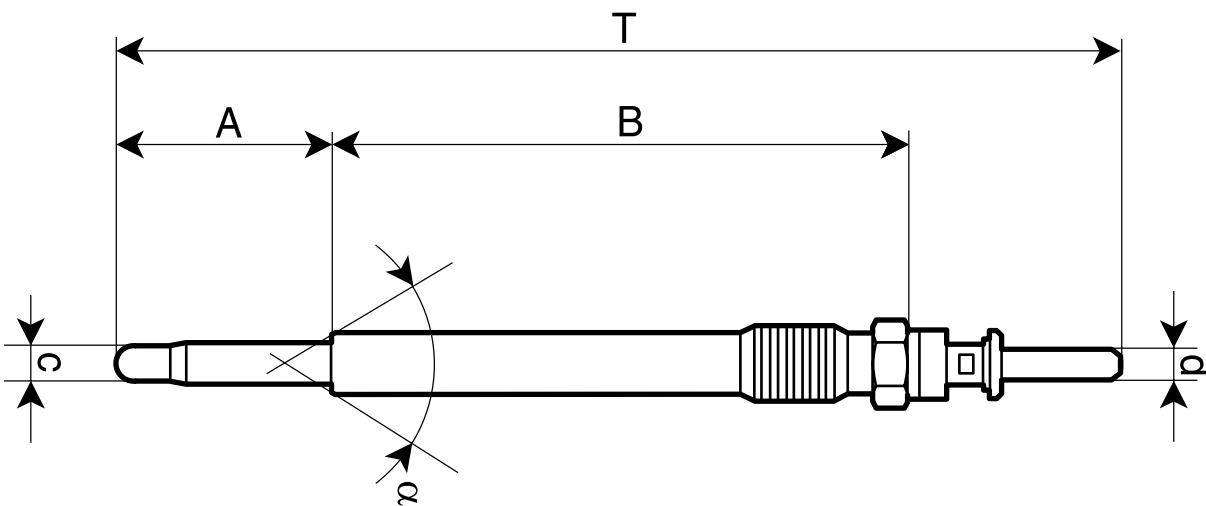

UC16A



T	132,5		M10x1
A	28,5		10
B	76	V	11
c	5	Amp	10
d	4		7"
a	63	Nm	10-15

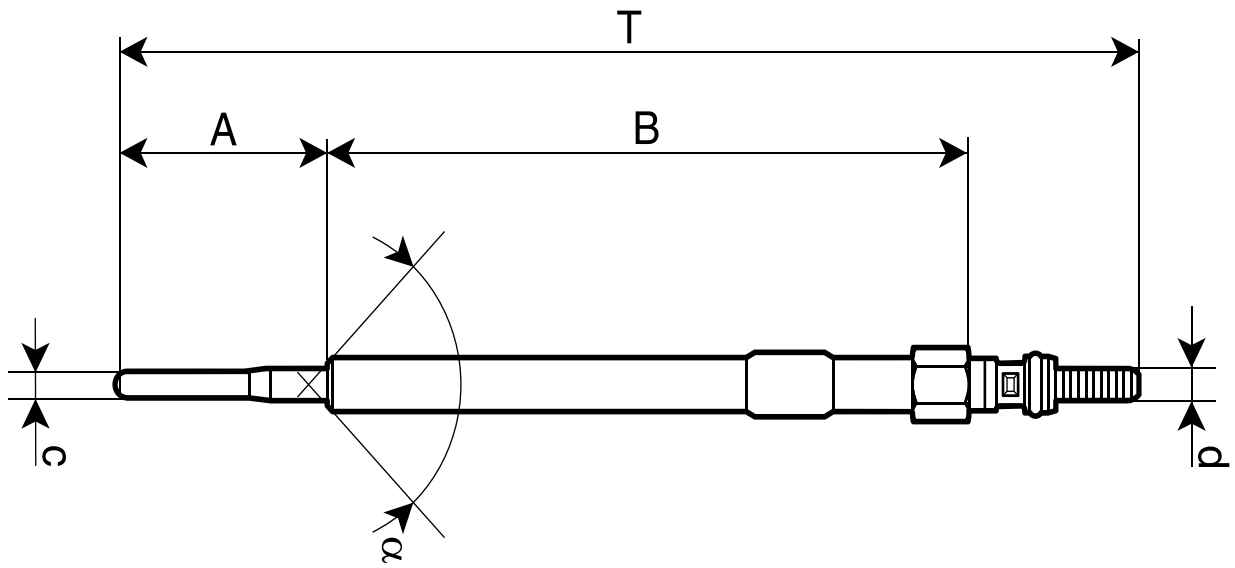

UY81A



T	135		M8x1
A	27,5		8
B	85	V	7 a 4,4
c	4	Amp	7
d	4		4"
alpha	93	Nm	8-10

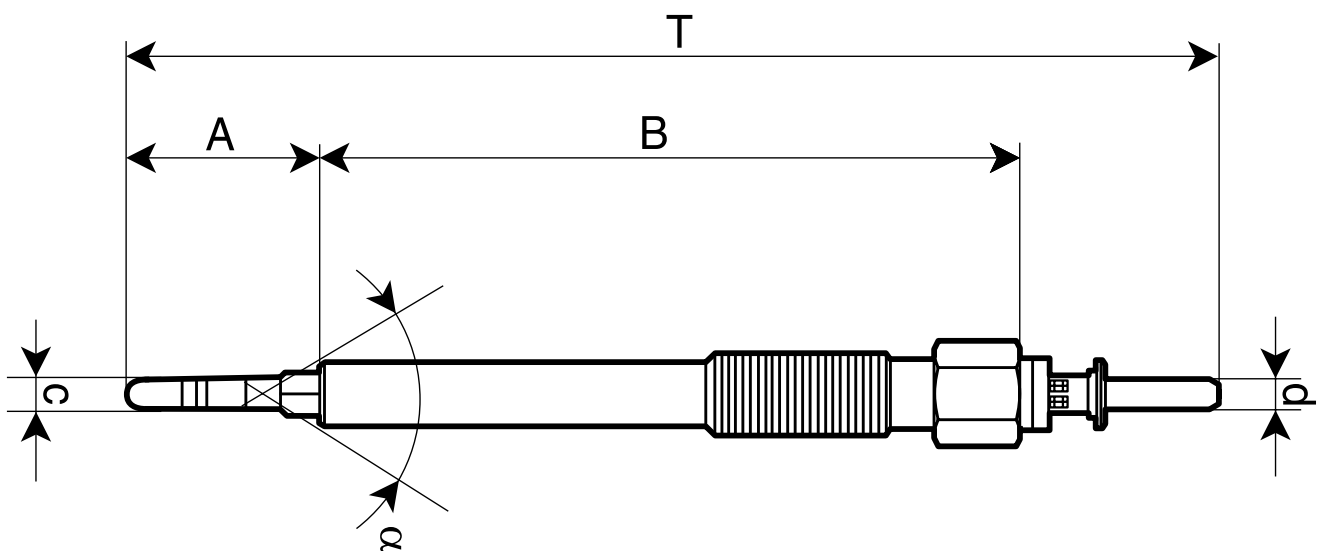

UZ2A



T	144		M10x1,25
A	24		12
B	93	V	11
c	4,5	Amp	4
d	4		4"
alpha	12	Nm	10-12

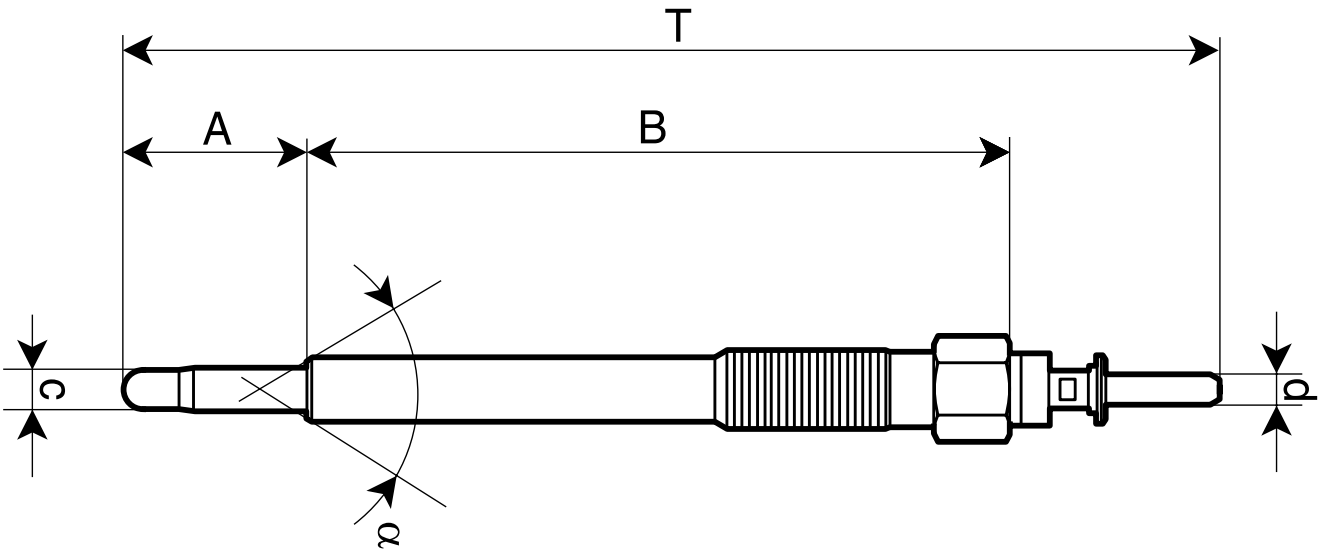

**UZ2B**

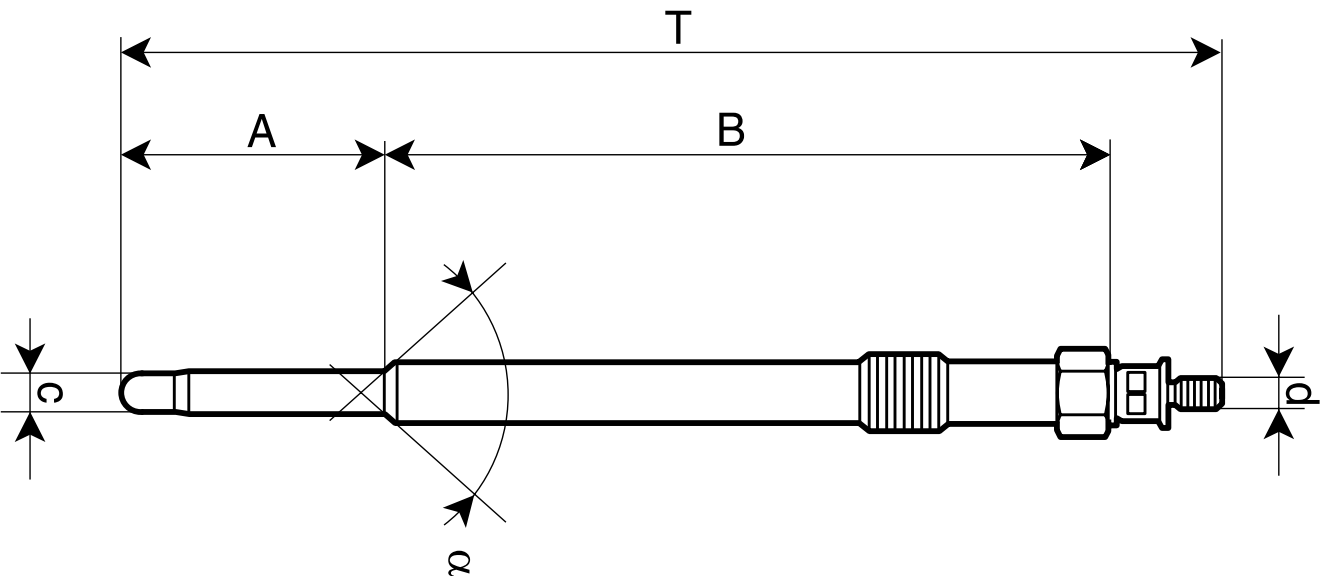

T	145,6		M10x1,25
A	24		12
B	93	V	11
c	5	Amp	10
d	4		7"
a	119	Nm	10-18

**UC27A**



T	146,1		M10x1
A	35		10
B	96	V	11,5
c	5	Amp	10
d	4		7"
a	93	Nm	10-15



UC82A

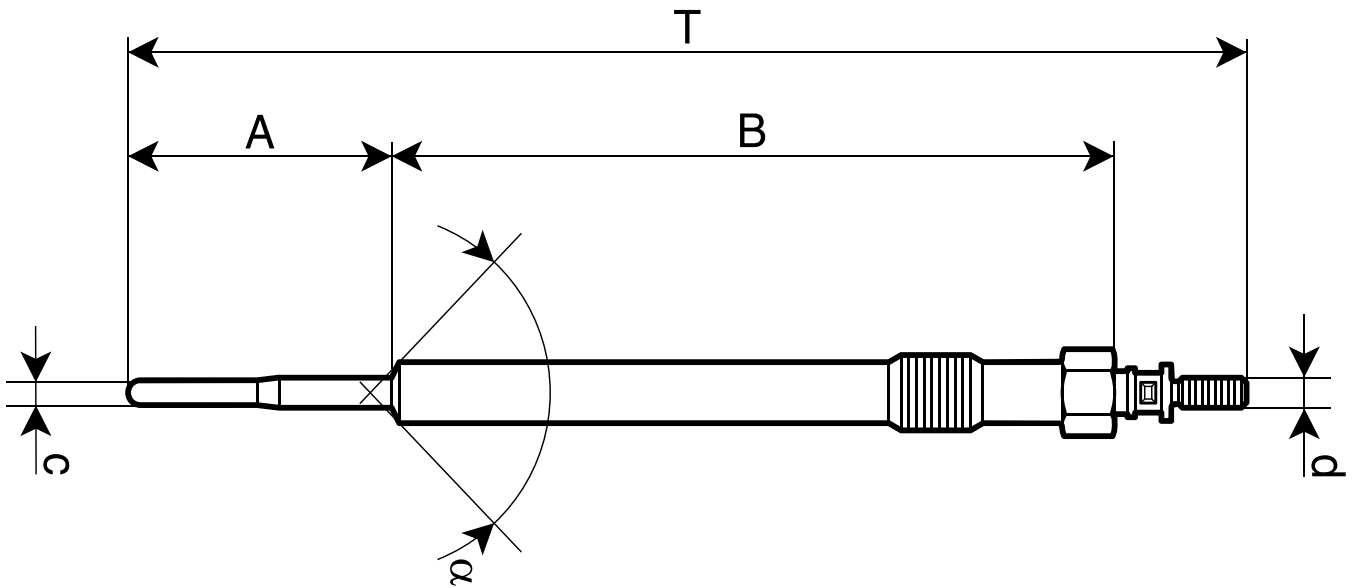

T	145,8		M10x1
A	36		10
B	96	V	4,4
c	4	Amp	4.4
d	4		4,5"
α	93	Nm	10-15

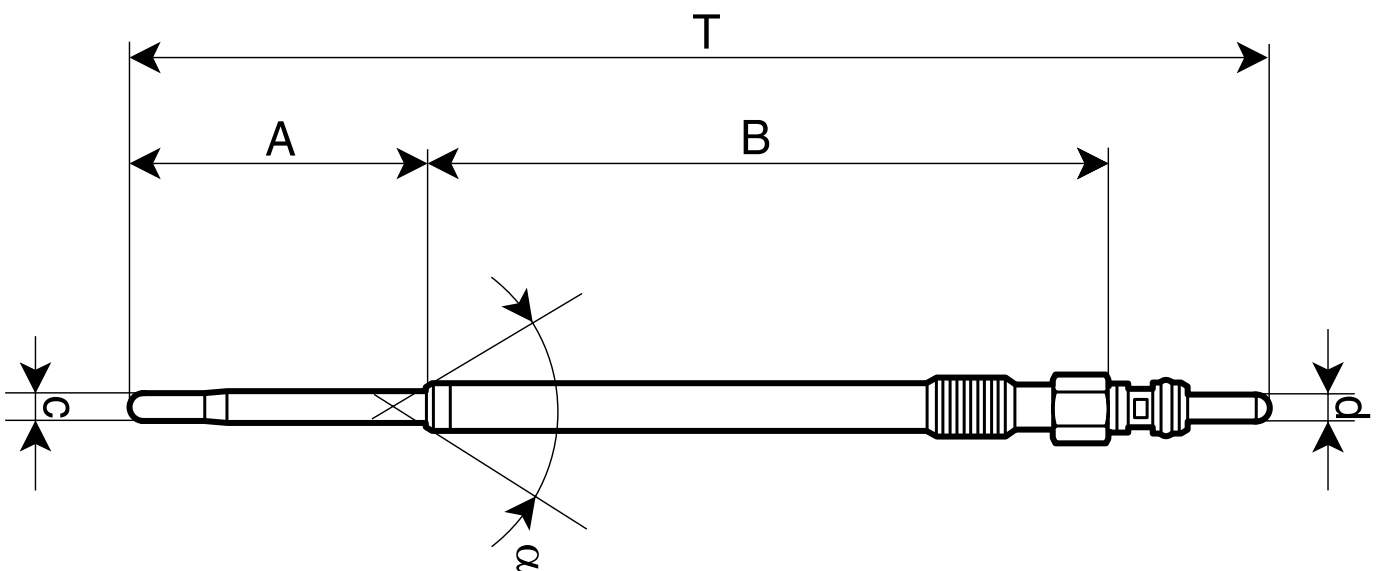

UY6A



T	150,9		M8x1
A	39,5		8
B	90	V	11
c	4	Amp	10
d	4		4,5"
α	93	Nm	8-12

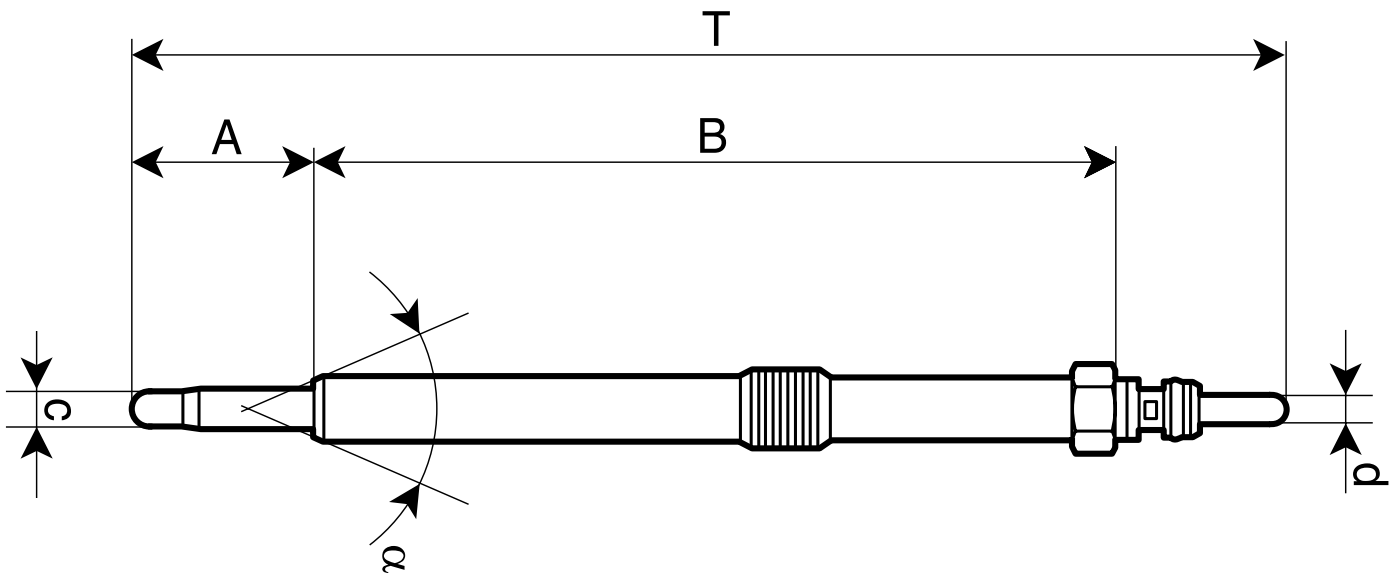

**UC29A**

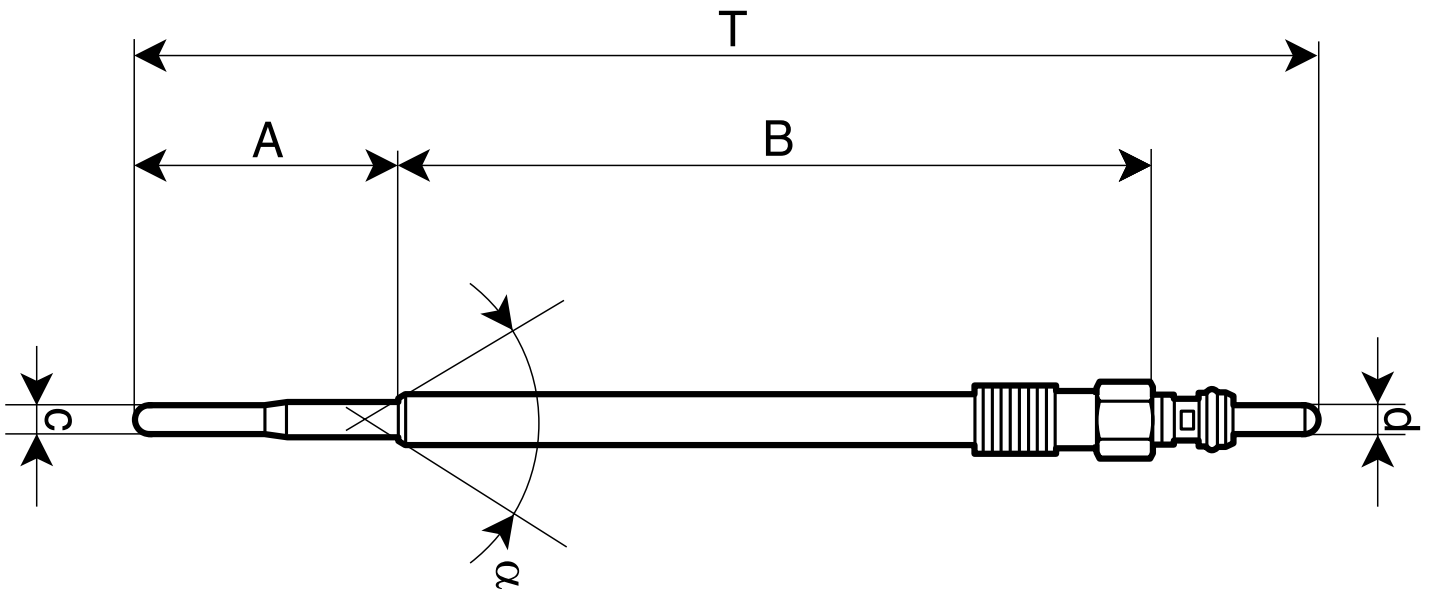

T	151		M10x1
A	24		10
B	105	V	11
c	5	Amp	10
d	4		7"
a	63	Nm	10-15

**UY10A**



T	156,4		M9x1
A	35		9
B	100	V	4,4
c	4	Amp	8,5
d	4		4"
a	93	Nm	8-12

UZ80B

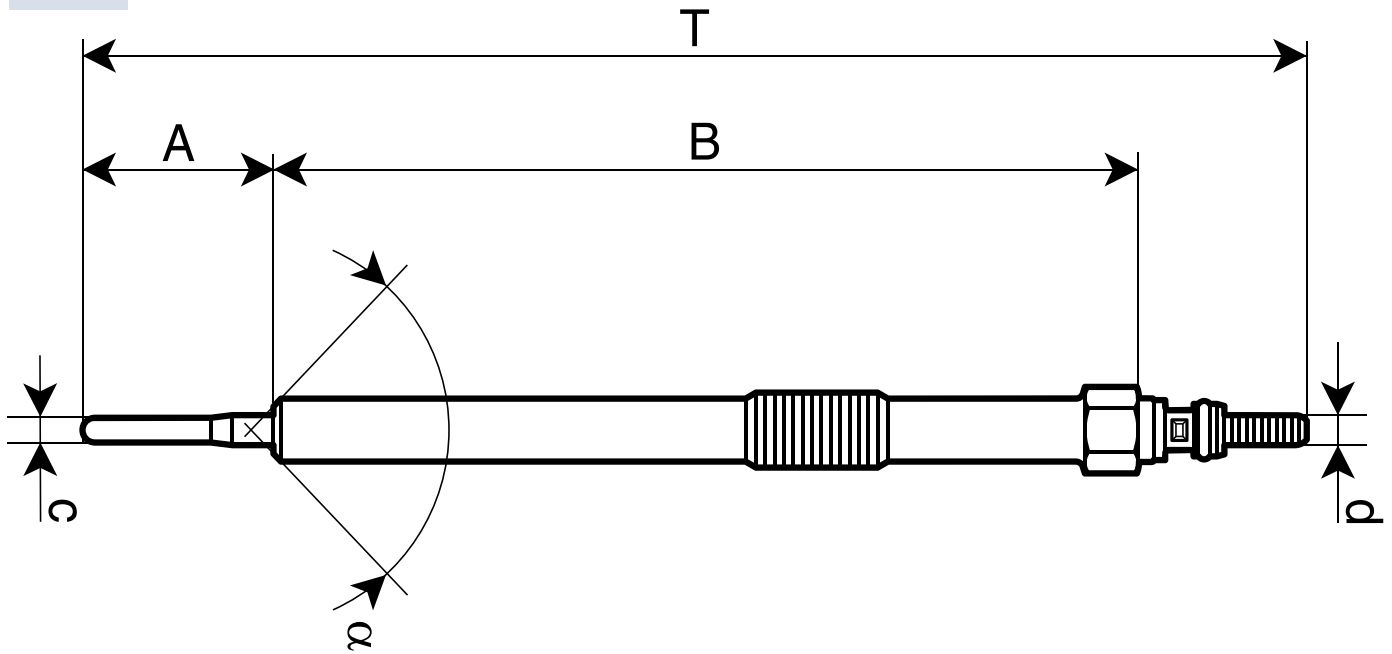

T	163,4		M10x1
A	25,5		10
B	115,5	V	7
c	4	Amp	7
d	4		4"
alpha	93	Nm	10-15

UC35A

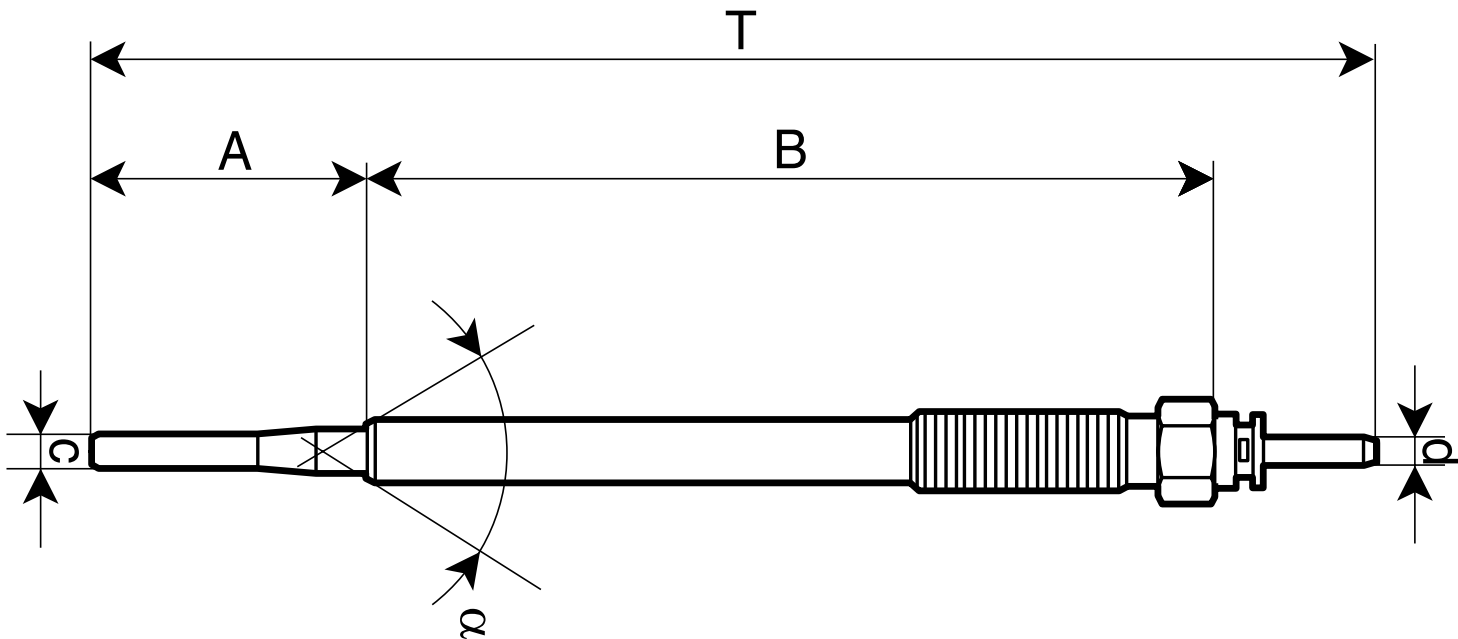

T	170		M10x1,25
A	36,5		12
B	112	V	11
c	5	Amp	10
d	10		7"
alpha	93	Nm	10-18



**Bujías de Pre calentamiento**  
Equivalencias por código

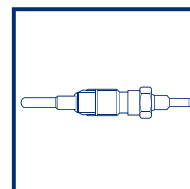

<b>BOSCH</b>	<b>MAGNETI MARELLI</b>
0250.201.032	UX8A
0250.201.034	UX7A
0250.201.036	UX27A
0250.201.038	UX16A
0250.201.039	UX2A / UX4A / UX5A / UX9A
0250.201.041	UX13A
0250.201.042	UX20A
0250.201.049	UX19A
0250.201.050	UX18A
0250.202.001	UX11A / UX12A
0250.202.002	UC2A / UC37A
0250.202.020	UC15A
0250.202.022	UC31A
0250.202.023	UC14A
0250.202.024	UX22A
0250.202.025	UC8A
0250.202.026	UX23A
0250.202.028	UC11A
0250.202.029	UC17A
0250.202.032	UC12A
0250.202.034	UC4A
0250.202.035	UC21A
0250.202.036	UC19A
0250.202.040	UC24A
0250.202.042	UC16A
0250.202.043	UC28A
0250.202.085	UC10A
0250.202.087	UC9A
0250.202.093	UC36A
0250.202.094	UC23A
0250.202.095	UC38A
0250.202.103	UC26A
0250.202.125	UC35A
0250.202.128	UC29A
0250.202.129	UC30A
0250.202.130	UC27A
0250.202.131	UC22A

0250.203.002	UY2A
0250.203.003	UY2A
0250.203.004	UY4A
0250.204.001	UY1A
0250.204.002	UY5A
0250.312.003	UZ1B
0250.312.007	UZ4B
0250.402.001	UC01F
0250.402.002	UC02F
0250.403.003	UY11A
0250.406.005	UY10A
0 250 403 009	UY7A
0250.603.001	UZ80B

<b>CHEVROLET</b>	<b>MAGNETI MARELLI</b>
3 805 511	UY11A
12 14 032	UY2A
9118201	UC16A
93187927	UZ2A
70998193 / MI074192	UC24A
MI074192 - 93321136	UZ1A
95 440 144	UY11A
97210818	UZ2A
97358626	UZ2A
97358626 / 97210818	UZ2B
97389905	UZ2A

<b>CITROËN</b>	<b>MAGNETI MARELLI</b>
1148105	UY1A
5960 39	UC37A
5960 67	UC12A
5960 78	UY5A
5960 79	UY5A
5960 H6	UC40A
5962 1P	UC40A
5962 1Q	UC40A

FIAT	MAGNETI MARELLI
1045497	UX20A
71735462	UC2A
7735920	UX20A
500351992	UY6A
46 779 614	UY2A
46 796 050	UY2A

FORD	MAGNETI MARELLI
1079401	UC22A
1148105 - 1525910	UX19A
1525910	UY1A
7088988	UX11A
90/579412/0/13	UC24A
R/ZD/4	UX11A

HESCHER	MAGNETI MARELLI
639	UY11A
632	UY10A
351	UY2A

HYUNDAI	MAGNETI MARELLI
36710-27000 / 36710-27010	UC33A

ISUZU	MAGNETI MARELLI
8-94133759-8/8-94175158-1	UC10A

JEEP	MAGNETI MARELLI
68147404AA	UY10A

MERCEDES BENZ	MAGNETI MARELLI
0001592001	UX17A

MITSUBISHI	MAGNETI MARELLI
MD 197511	UZ4B

NISSAN	MAGNETI MARELLI
1106500Q0C	UZ80B

PEUGEOT	MAGNETI MARELLI
5962 03	UC15A
5960 68	UC15A
5960 66	UC12A
5960 39	UC37A
5960 78	UY5A
5960 79	UY5A
5960 H6	UC40A
5962 1P	UC40A
5962 1Q	UC40A

RENAULT	MAGNETI MARELLI
7700100558	UC21A
7700100635	UC30A
7700100586	UC31A
8200490950	UC31A
7700111323	UC31A
7700734956	UX14A
7700855865	UX14A
7700856238	UX14A
7701349943	UX14A
8200561251	UZ80B

**TOYOTA****MAGNETI  
MARELLI**

19850-54130

**UC53A****VOLKSWAGEN****MAGNETI  
MARELLI**

N/102130/02

**UX8A**

N/101401/05

**UC31A**

N/102130/02

**UX8A**







**Magneti Marelli Repuestos S.A.**  
**Andonaegui 1035 . C1427BEC**  
**Ciudad Autónoma de Buenos Aires . República Argentina**  
**0800 - 555 - MARELLI (6273554)**  
**[mmr.asistenciatecnica@magnetimarelli.com](mailto:mmr.asistenciatecnica@magnetimarelli.com)**  
**[www.magnetimarelli.com.ar](http://www.magnetimarelli.com.ar)**





 [www.magnetimarelli.com.ar](http://www.magnetimarelli.com.ar)

 **Magneti Marelli Argentina**



## **ARGENTINA**

**Magneti Marelli Repuestos S.A.**

Hipólito Yrigoyen 571 - 8°Piso - B1638BGP

Vicente López - Provincia de Buenos Aires - República Argentina

0800 - 555 - MARELLI (6273554)

[mmr.asistenciatecnica@magnetimarelli.com](mailto:mmr.asistenciatecnica@magnetimarelli.com)

[www.magnetimarelli.com.ar](http://www.magnetimarelli.com.ar)